



Voyager Pro Kit 2020+ RR

Part# AB-21999-RR

2020+ 125-300RR, 2 & 4 Stroke Race Editions

Installation Instructions:



1. Remove the seat , fuel tank and headlight mask
2. Unplug all the wires from the speedometer and the speedometer bracket. Remove the speedometer and bracket.



3. Drain the cooling system by removing the lower water pump cover bolt and copper washer. (4 stroke Photo) or by removing the cooling system drain bolt on the water pump cover (2 stroke photo). Loosen the radiator cap to start the flow of coolant into a clean container for reuse.

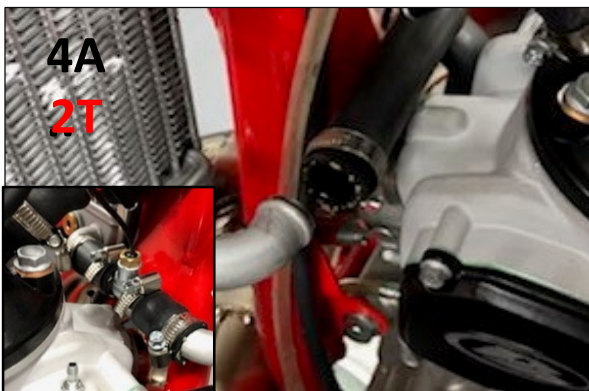

4. **4A. 2 Stroke** - Remove the straight hose connecting the radiators and cut the hose in the middle . Insert the temperature sensor "T" between the 2 pieces then use the two supplied hose clamps to secure it (photo). Re install the hose and run the temperature sensor lead up to the speedometer bracket area. **4B. 4 Stroke** - Remove the lower left radiator hose and cut it In the middle (photo). Cut a V in each inside opposing edge slightly off center (Photo). **4C.** Insert the temperature sensor "T" between the two holes and secure it with the two supplied hose clamps. Re install the hose and run the temperature sensor lead up to the speedometer bracket area. Re install the drain bolt and copper washer then refill the cooling system.

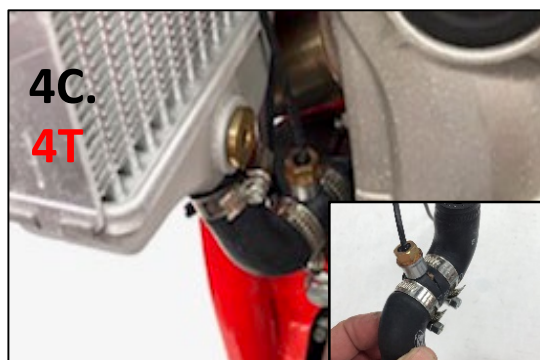



Voyager Pro Kit 2020+ RR

Part# AB-21999-RR

2020+ 125-300RR, 2 & 4 Stroke Race Editions

Installation Instructions:



5. Install the Tachometer pick up lead on the spark plug wire by wrapping the red end around the spark plug wire near the cap 5 times then securing with the 2 small supplied zip ties (Photo). Run the pick up lead up to the speedometer bracket area.



6. Find the blinker flasher plug and cut a small opening in the middle of the outer harness cover (photo). Secure the red T-Tap with pliers crimping it to the red wire on a 2 stroke and a white/blue wire on a 4 stroke.

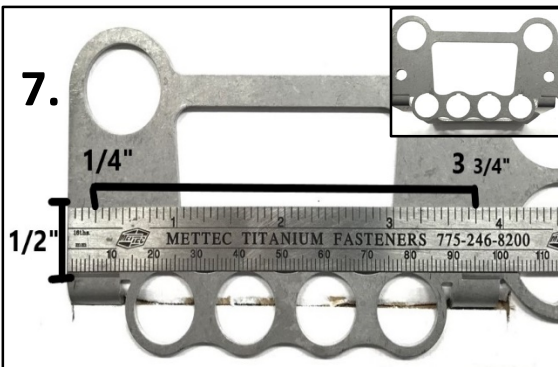

7. Drill 2 quarter inch holes in the top of the supplied stainless steel bracket. First mark the location using the measurements in the photo then use a punch for a starting point for drilling.

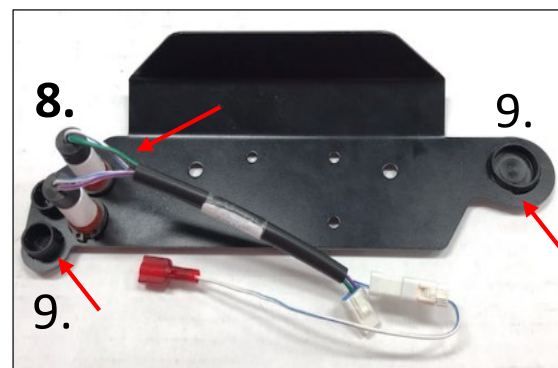

8. Insert the two indicator lamp housings into the desired positions of the black bracket. Use a supplied O-ring then circlip to retain the housings. Insert the hole plugs in the remaining unused locations

9. Install the 2 small and 1 large hole plugs. Insert the two indicator LED's into the housing. Make sure the LED with the green/brown wire goes to the low fuel/oil housing. On the 4 Stroke Models this is opposite.

10. Use the trail tech mounting hardware to secure

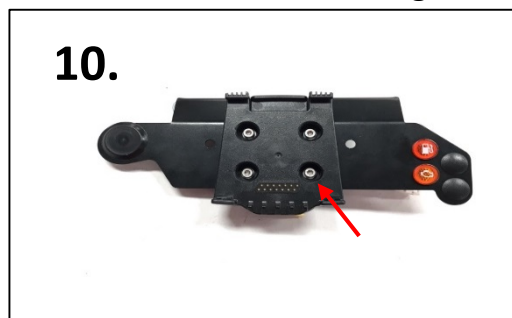



Voyager Pro Kit 2020+ RR

Part# AB-21999-RR

2020+ 125-300RR, 2 & 4 Stroke Race Editions

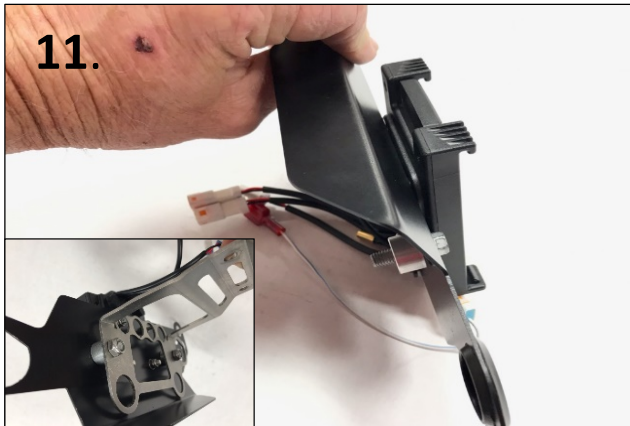

11. Secure the black bracket to the stainless bracket using the two supplied M6x20 bolts, 9.5 mm spacers and 6mm nylock nuts. The spacers are placed between the two brackets.



12. Install the main harness plugs into the slots of the stainless bracket. Remove the harness clamp nut from the stock bracket and install it into the stainless bracket.

Connect any antennas to the dock now.
Attach the bracket assembly to the top triple clamp using the 2 supplied M6x16 bolts.

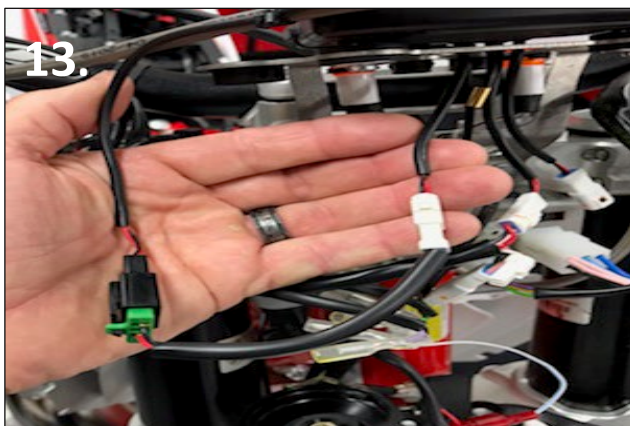

13. Install the speedometer adapter plug, one end to the speedometer sensor plug and the other end to the voyager pro dock plug.



14. Connect the larger plug from the indicator lamps to the correct plug of the main harness and the other to the "T Tap". (Photo)



Voyager Pro Kit 2020+ RR

Part# AB-21999-RR

2020+ 125-300RR, 2 & 4 Stroke Race Editions

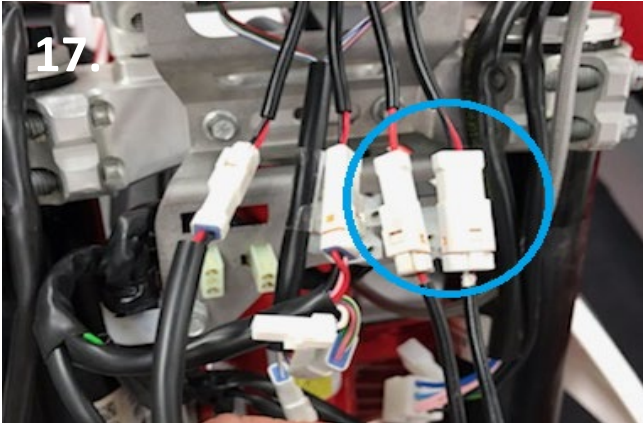

17. Connect the tach sensor and temperature sensor wires to the correct plugs of the dock.



18. Reconnect all the factory plugs then secure all leads and wiring using the supplied zip ties.

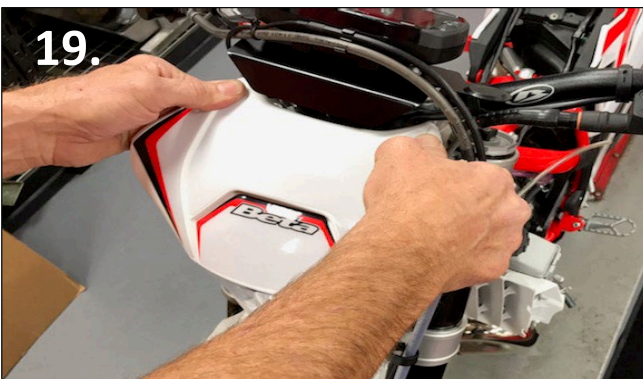

19. Connect the headlight plugs then insert the headlight mask locating pins into the front fender locating holes. Push down on the top of the mask bending it down then move it behind the black bracket and release it. Secure the mask straps.



20. Attach the Voyager Pro head unit to the dock.

You are now ready to use your Beta Voyager Pro unit.