



RC 450 4T

Thanks for your preference, and have a good time! This handbook contains the information you need to properly operate and maintain your motorcycle.

The data, specifications and images shown in this manual does not constitute an engagement on the part of BETAMOTOR S.p.A. BETAMOTOR reserves the right to make any changes and improvements to its models at any moment and without notice.

Code 049.44.006.83.00

IMPORTANT

We recommend you to check all the tightenings after the first one or two hours' ride over rough ground. Special attention should be paid to the following parts:

- rear sprocket
- ensure that the footrests are properly fixed
- front/rear brake levers/calipers/discs
- check that the plastics are properly fastened
- engine bolts
- shock absorber bolts/swingarm
- wheel hubs/spokes
- rear frame
- pipe connections
- tensioning the chain

IMPORTANT

In the event of interventions on the vehicle, contact Betamotor after-sales service.

The operations specified in the maintenance schedule must be performed exclusively at an authorised Betamotor workshop and must be registered on the Betanet portal. Failure to register will result in rendering the warranty null and void.

Use of the vehicle in heavy-duty conditions, for example, on sand, circuits/off-road tracks with wet, dusty or muddy terrain, can result in above-average wear of components such as the drive system, brake system, air filter or suspension parts. Therefore, inspection or replacement of the components may be necessary even before the first service is due.

CONTENTS	
Operating instructions.....	5
Symbols.....	5
Riding safety	6
CHAPTER 1 GENERAL INFORMATION	7
Vehicle identification data	8
Tools kit	8
Familiarizing with the vehicle.....	9
Specifications	10
Fuses	13
Recommended lubricants and liquid	13
Electrical system.....	14
CHAPTER 2 OPERATION	15
Main parts	16
Checks before and after use	18
Running in.....	18
Fuelling.....	19
Starting the engine	20
Engine shut-down	20
Vehicle preparation for use in heavy-duty conditions.....	21
CHAPTER 3 ADJUSTMENTS.....	23
Key to symbols.....	24
Brakes	24
Clutch.....	25
Adjustment of gas clearance.....	25
Idle adjustment	25
Handlebar adjustment	26
Adjusting fork	27
Shock absorber.....	28
Engine mapping adjustment and traction control activation	30
CHAPTER 4 CHECKS AND MAINTENANCE	31
Engine oil.....	32
Gearbox oil	34
Liquid coolant	35
Air filter	38
Spark plug	41

Front brake.....	42
Rear brake	45
Clutch control	48
Check and adjusting of steering play.....	50
Fork.....	51
Front wheel	51
Tyres.....	52
Rear suspension leverage.....	52
Chain	53
Battery.....	55
Fuses	57
Cleaning the vehicle.....	58
Electrical connector maintenance	59
Prolonged inactivity	61
Scheduled maintenance vehicle	62
Tightening torque overview	64
CHAPTER 5 REMOVING AND INSTALLING SUPERSTRUCTURES	67
Removing and installing of the saddle.....	68
Removing and installing air filter cover panel.....	69
Removing and installing side panels and rear mudguard	70
Removing and installing of the tank	72
Removing and installing the front mask	75
CHAPTER 6 TROUBLESHOOTING	77
Troubleshooting	78

OPERATING INSTRUCTIONS

- To protect your safety and that of others, always drive carefully and with your helmet.
- Do not start the engine in closed places.

WARNING

Any modifications and tampering with the vehicle during the warranty period exempt the manufacturer from all responsibility and invalidate warranty.

SYMBOLS



SAFETY/ATTENTION

Failure to respect information marked with this symbol can entail a personal hazard.



INTEGRITY OF THE VEHICLE

Failure to respect information marked with this symbol can entail serious damage to the vehicle and termination of the warranty.



FLAMMABLE LIQUID HAZARD



Read the use and maintenance manual carefully.



MANDATORY TO WEAR PROTECTIVE CLOTHING

Use of the vehicle is subject to wearing specific protective clothing and safety footwear.



PROTECTIVE GLOVES MANDATORY

To perform the operations described, it is mandatory to wear protective gloves.



FORBIDDEN TO USE NAKED FLAMES OR POSSIBLE UNCONTROLLED IGNITION SOURCES



NO SMOKING



DO NOT USE MOBILE PHONE



CORROSIVE SUBSTANCES HAZARD

Liquids marked with this symbol are highly corrosive: handle with care



POISONING HAZARD

RIDING SAFETY

- Ride only on track, on-road use is not allowed.
- Always wear approved personal protective equipment.
- Always keep the crash helmet visor clean.
- Do not keep sharp or brittle objects in your pockets while riding.
- Always ride in a seated position, with both hands on the handlebars and both feet on the footrests.
- Never ride abreast with other vehicles.
- Always keep a safe distance from other vehicles.
- Do not start off while the vehicle is on its stand.
- Avoid swaying and wheelies as they are extremely dangerous for your own and other people's safety as well as for your vehicle.
- Always apply both brakes on dry roads with no gravel and sand. Using one brake may be dangerous and cause uncontrolled skidding.
- To reduce the braking distance, always apply both brakes.

CHAPTER 1 GENERAL INFORMATION**CONTENTS**

Vehicle identification data	8
Frame identification	8
Engine identification	8
Tools kit	8
Familiarizing with the vehicle.....	9
Main parts.....	9
Specifications	10
Weight.....	10
Dimensions	10
Tyres	10
Wheels	10
Capacities	10
Front suspension	11
Rear suspension	11
Front brake	11
Rear brake	11
Engine	12
Fuses	13
Recommended lubricants and liquid	13
Electrical system.....	14
Electrical diagram	14
Legend.....	14

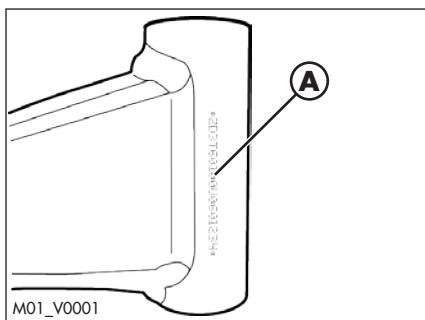

VEHICLE IDENTIFICATION DATA

FRAME IDENTIFICATION

Frame identification data **A** are stamped on the right side of the steering head tube.

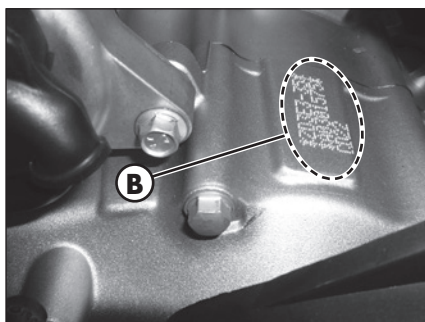

ENGINE IDENTIFICATION

Engine identification data **B** are stamped in the area shown in the figure.

TOOLS KIT

The following items are supplied as standard: operation, maintenance manual, tool kit and the side stand.

FAMILIARIZING WITH THE VEHICLE

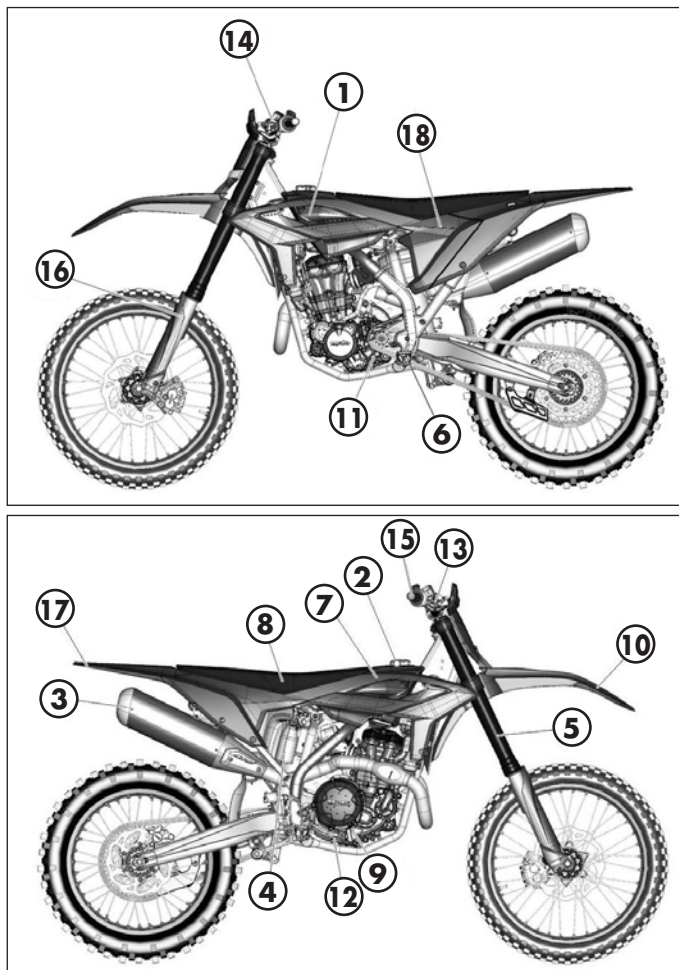

MAIN PARTS

- | | |
|-------------------------|------------------------|
| 1 - Fuel tank | 10 - Front mudguard |
| 2 - Tank cap | 11 - Gear lever |
| 3 - Silencer | 12 - Rear brake lever |
| 4 - Rear shock absorber | 13 - Front brake lever |
| 5 - Fork | 14 - Clutch lever |
| 6 - Rider's footrests | 15 - Throttle |
| 7 - Front side panel | 16 - Fork covers |
| 8 - Saddle | 17 - Rear mudguard |
| 9 - Engine | 18 - Air filter cover |

SPECIFICATIONS

WEIGHT

Weight in running order with full fuel

Version	Total [kg]	Front [kg]	Rear [kg]
RC 450	104,5	51,4	53,1

DIMENSIONS

maximum length.....	2170 mm
maximum width	830 mm
overall height	1270 mm
wheelbase.....	1475 mm
saddle height.....	945 mm
ground clearance.....	335 mm
footrest height.....	422 mm

TYRES

Dimensions		Pressure [Bar]	
Front tyre	Rear tyre	Front tyre	Rear tyre
90/90-21	140/80-18	1 (off-road use)	1 (off-road use)

WHEELS

Version	Dimensions	
	Front	Rear
RC 450	J 21x1.6	J 18x2,15

CAPACITIES

Version	RC 450
Fuel tank * [l]	9
Coolant circuit [ml]	1400
Engine oil [ml] (following normal maintenance work)	750
Engine oil [ml] (following a complete engine review)	800
Gear oil [ml] (following normal maintenance work)	750
Gear oil [ml] (following a complete engine review)	800

*Such data is referred to a conditioned and arranged tank

FRONT SUSPENSION

Closed cartridge hydraulic upside-down fork

Spring (K-N/mm) K 4,9

Oil type KYB Fork Oil 01M

Oil quantity * 545 g

Compression clicks (from completely closed) 12

Rebound clicks (from completely closed) 14

Wheel excursion 305 mm

* For a completely dry fork

REAR SUSPENSION

Single shock absorber with compound lever

Spring (K-daN/mm) K 5,4

Static sag load (see page 29) 35 mm

Compression clicks, high speeds (from completely closed) 2

Compression clicks, low speeds (from completely closed) 26

Rebound clicks (from completely closed) 16

Shock absorber travel 130 mm

Rear wheel travel 300 mm

FRONT BRAKE

Ø 260 mm disc and dual-piston floating caliper

REAR BRAKE

Ø240 mm disc and single-piston floating caliper

ENGINE

Version	RC 450
Type	Single-cylinder, 4-stroke
Bore x stroke [mm]	97 x 60,8
Displacement [cm ³]	449,3
Compression ratio	13,5:1
CO ₂	10,7%

Fuel system.....electronic injection, double injector

Cooling system forced liquid circulation by pump

Spark plug NGK LKAR 8A - 9

Clutch.....wet, multidisc

Transmission 5-speed with front claw clutch

Version	RC 450
Primary drive	31/72
Gear ratio 1 st gear	14/29
Gear ratio 2 nd gear	16/27
Gear ratio 3 rd gear	19/27
Gear ratio 4 th gear	20/24
Gear ratio 5 th gear	26/24
Final drive	13/51

Starting..... electric starter

FUSES

Two 10A
one of them spare

RECOMMENDED LUBRICANTS AND LIQUID

To maximize the vehicle's performance and ensure many years of trouble-free operation, we recommend using the following products:

PRODUCT TYPE	SPECIFICATIONS
FUEL	GASOLINE  95 RON
ENGINE OIL	LIQUI MOLY MOTORBIKE 4T SYNTH 10W-50 OFFROAD RACE
GEAR AND CLUTCH OIL	LIQUI MOLY MOTORBIKE 4T SYNTH 10W-50 OFFROAD RACE
BRAKE OIL	LIQUI MOLY BRAKE FLUID DOT 5.1
CLUTCH ACTUATOR OIL	LIQUI MOLY BRAKE FLUID DOT 5.1
FORK OIL	KYB FORK OIL 01M
TIE ROD GREASE	LIQUI MOLY SCHMIERFIX
LIQUID COOLANT	LIQUI MOLY COOLANT READY MIX RAF 12+

Note:

It is essential that all renewals should be performed with the products listed in the table above.

ELECTRICAL SYSTEM

ELECTRICAL DIAGRAM

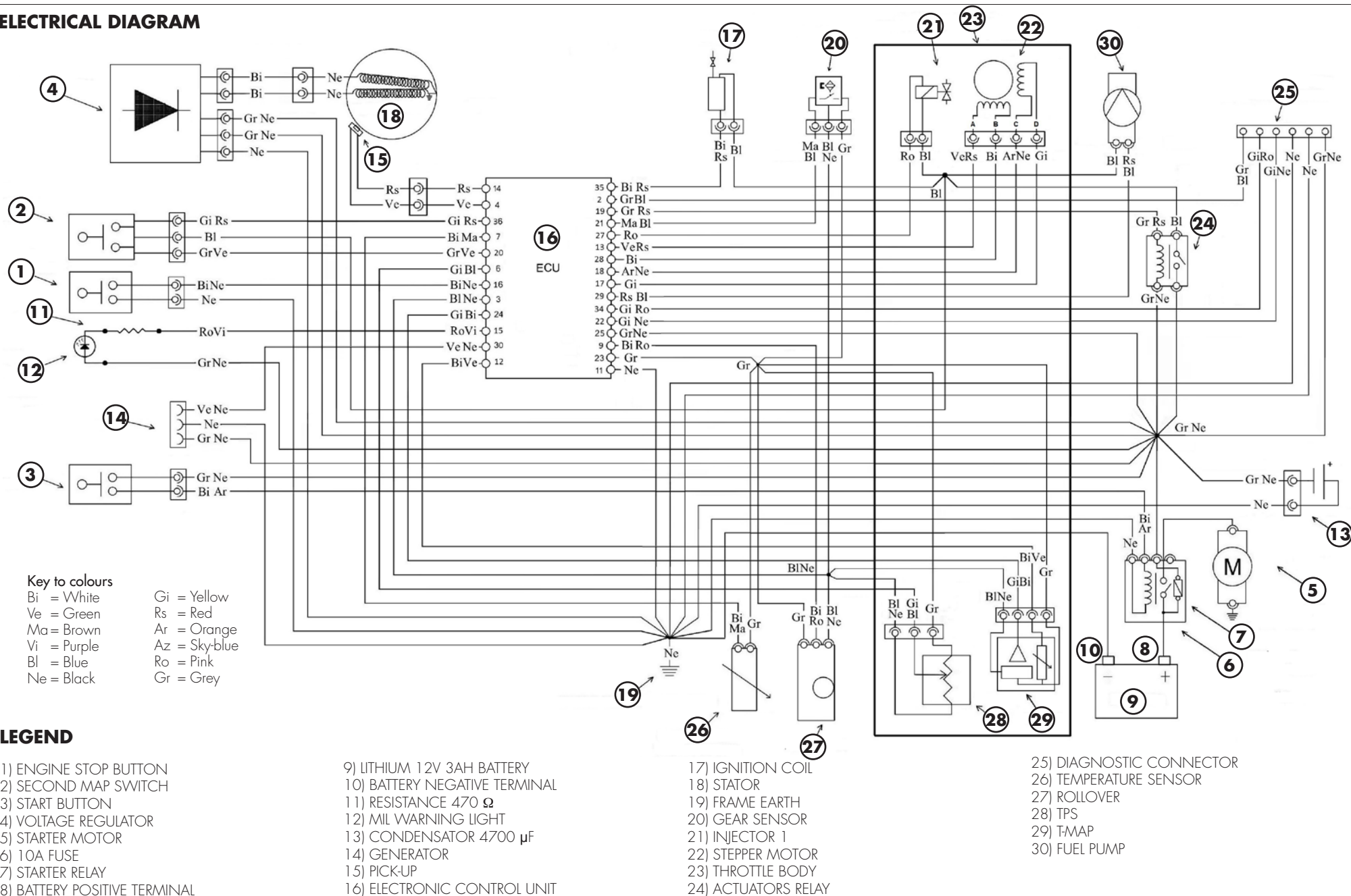

CHAPTER 2 OPERATION**CONTENTS**

Main parts	16
Fuel tank cap	16
Clutch lever	16
LH switch	16
RH switch	16
Front brake lever and gas control	17
MIL warning light	17
Gear change lever	17
Brake pedal	17
Checks before and after use	18
Running in	18
Fuelling	19
Starting the engine	20
Engine shut-down	20
Vehicle preparation for use in heavy-duty conditions	21

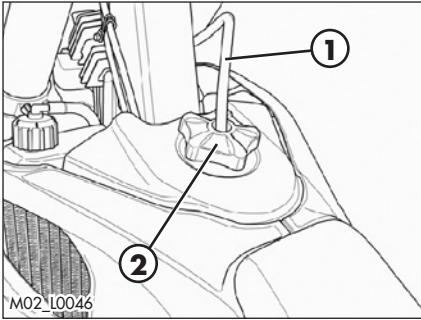

MAIN PARTS

FUEL TANK CAP

Disconnect the ventilation pipe **1**.

To open the tank turn the cap **2** anticlockwise.

To close the fuel tank's cap, set it on the tank and crew it clockwise.

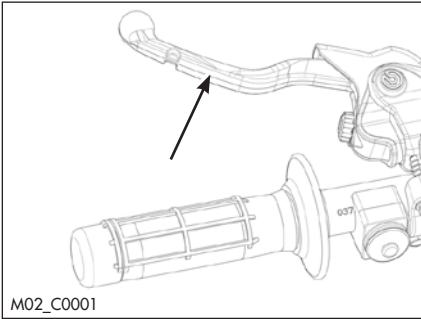

CLUTCH LEVER

Clutch lever is fitted to the left-hand side of the handlebars.

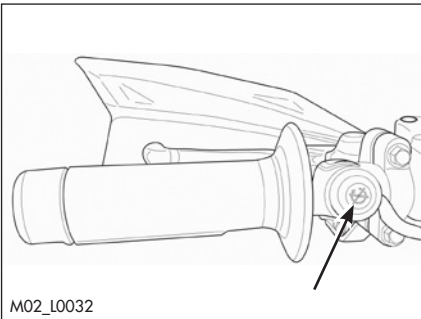

LH SWITCH

The button turns off the engine.

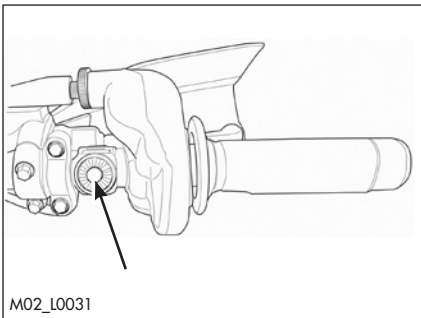

RH SWITCH

Starter button is located on the right-hand side of the handlebars and operate the electric engine starter. For startup, refer to paragraph page 20. Do not press the button while the engine is running.

FRONT BRAKE LEVER AND GAS CONTROL

The front brake lever **A** and the gas throttle **B** are located on the right side of the handlebar.

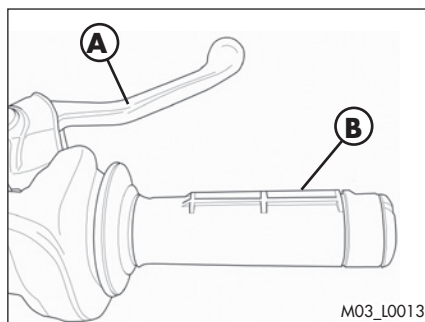

MIL WARNING LIGHT

The MIL warning light indicates a malfunction in the engine management system. This condition occurs **ONLY** while the engine is running. Contact as soon as possible an authorized Betamotor.

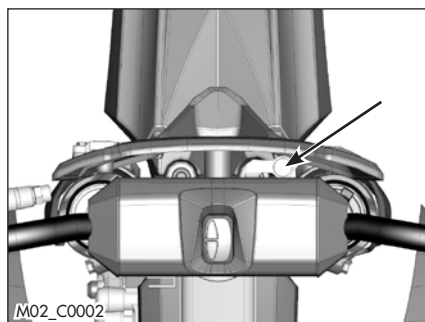

GEAR CHANGE LEVER

Gear change lever is fitted to the left side of the engine. The positions corresponding to the different gears are shown in the figure.

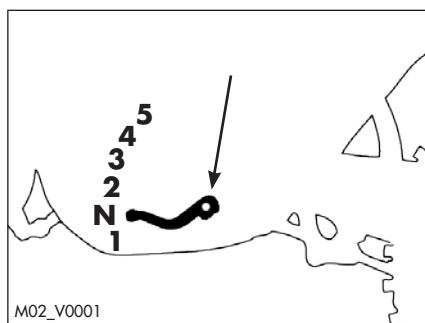

BRAKE PEDAL

Brake pedal is located in front of the right-hand footrest.

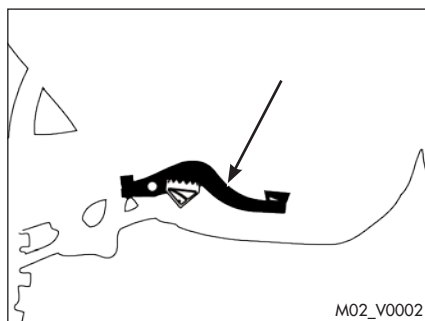

2 CHECKS BEFORE AND AFTER USE

For safe driving and long vehicle life you should:



1 Check all fluid levels.



2 Check the correct operation of the brakes and brake pad wear (I).



3 Check pressure, general condition and thickness of tread.

4 Check that the spokes are properly tightened.

5 Check the tensioning of the chain (page 53).



6 Check the adjustment and the operation of all the cable controls.



7 Inspect all the nuts and bolts.

8 Wash the motorcycle thoroughly after off-road use (page 58)

RUNNING IN

The running-in period lasts approximately 15 hours, during which it is advisable to:

- 1 During the first 3 hours of operation the engine should only be used to approximately 50 percent of its power. In addition, the engine speed should not exceed 7,000 rpm.
- 2 For the next 12 hours of operation the engine should only be used to about 75 percent of its power.

WARNING

After the first 3 hours change the engine and gear oil.

This procedure should be followed each time piston, piston rings, cylinder, crankshaft or crankshaft bearings are replaced.

FUELLING

See page 13 for the fuel specifications.

Fuel tank capacity is shown on page 10.

To refuel open the tank cap (page 16).

After refuelling, screw the cap back and tighten securely.

WARNING:

The refuelling should be performed with the engine off.

When the operation is finished, reconnect the ventilation pipe.



WARNING:

Fire hazard. Fuel is highly flammable.



Always stop the engine when refuelling and keep open flames and lighted cigarettes away.



Do not top up fuel while using a mobile phone.

Refuel in an open well ventilated area.

Pay special attention so that the fuel does not come into contact with hot parts of the vehicle. Immediately clean up any spilled fuel.



WARNING: Risk of poisoning.

Fuel is poisonous liquid and a health hazard.



Fuel must not come into contact with the skin, eyes, and clothing. Do not breathe in the fuel vapours. If contact occurs with the eyes, rinse immediately with plenty of water and seek medical advice. If contact occurs with skin, immediately clean contaminated areas with soap and water. If fuel is swallowed, contact a doctor immediately. Change clothing that is contaminated with fuel.

WARNING: Environmental pollution hazard.

The fuel must not contaminate the ground water, the ground, or the sewage system.

STARTING THE ENGINE

The bike starts ONLY with the battery mounted on the vehicle and connected to the electrical system.

Check that the gears are in neutral (page 17).

WARNING:

During start-up do not operate the throttle.

WHIT ELECTRIC STARTER (page 16):

Press the startup button for a max of 3 seconds. If the vehicle does not startup, wait 30 seconds before attempting a new startup.

NOTE

Pauses are needed to diffuse the generated heat and to avoid damaging the battery. If the battery is at a temperature below 15°C, the electric startup will be weak, not because the battery is deteriorated but because it needs to be warmed up. Therefore, with temperatures below 15°C, several startup attempts may be necessary to heat the battery and thereby increase the battery power provided by the battery.

Do not press the button while the engine is running.

ENGINE SHUT-DOWN

To shut-down the engine press the button  on the handlebar (page 16).

WARNING:

In case of fall the vehicle turns off after about 5 seconds.

VEHICLE PREPARATION FOR USE IN HEAVY-DUTY CONDITIONS

Using the vehicle in heavy-duty conditions, such as sand or wet or muddy soils, may require the corrective actions mentioned below.

The following are considered heavy-duty operating conditions:

- Dry sand
- Wet sand
- Particularly wet and muddy soils
- Driving in high temperature and low speed conditions
- Driving in low temperature and snow conditions

General actions:

- Verify filter and filter box cleaning (page 38)
- Verify tensioning and wear of the chain (page 53)
- Verify all electrical connectors, making sure they are well connected. Keep them dry and clean.

USE ON DRY SAND

- Apply specific protection against sand to the air filter
- Clean the chain
- Assemble a steel crown. For this operation contact the Betamotor service network. (Do not grease the chain!)
- Verify that the radiator fins are clean
- Verify that the radiator fins are not bent

USE ON WET SAND

- Apply an anti-water cap for the water filter
- Clean the chain
- Assemble a steel crown. For this operation, contact the Betamotor service network. (Do not grease the chain!)
- Verify that the radiator fins are clean
- Verify that the radiator fins are not bent

USE ON PARTICULARLY WET AND MUDDY SOILS

- Apply an anti-water cap for the water filter
- Assemble a steel crown. For this operation contact the Betamotor service network.
- Verify that the radiator fins are clean
- Verify that the radiator fins are not bent
- After use, proceed with washing (page 58)

DRIVING IN HIGH TEMPERATURE AND LOW SPEED CONDITIONS

- Adjust crown size based on the route.
Note: The oil has a tendency to heat up quickly when there is frequent clutch use and when using a crown whose dimensions are excessive. For this operation contact the Betamotor service network.
- Clean the chain
- Verify that the radiator fins are clean
- Verify that the radiator fins are not bent
- Verify cooling liquid level (page 35)
- For this use it is recommended to use an electric fan (optional). For the code, refer to the Betamotor accessory catalogue.

DRIVING IN LOW TEMPERATURE AND SNOW CONDITIONS

- Apply water protection to the air filter
- After use, proceed with washing (page 58)

CHAPTER 3 ADJUSTMENTS**CONTENTS**

Key to symbols.....	24
Brakes	24
Front brake	24
Rear brake	24
Clutch.....	25
Adjustment of gas clearance.....	25
Idle adjustment	25
Handlebar adjustment	26
U-bolt position adjustment.....	26
Adjustment of the handlebar position	27
Adjusting fork	27
Adjusting the rebound damper	27
Adjusting the compression damper	27
Shock absorber.....	28
Adjusting the rebound damper	28
Adjusting the hydraulic compression damper (high and low speeds)	28
Adjusting the spring preload	29
Static sag load test	29
Engine mapping adjustment and traction control activation	30

KEY TO SYMBOLS



Tightening torque



Threadlocker Medium

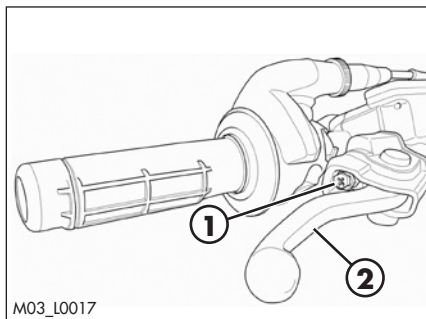



BRAKES

FRONT BRAKE

The front brake is disk type with hydraulic control.

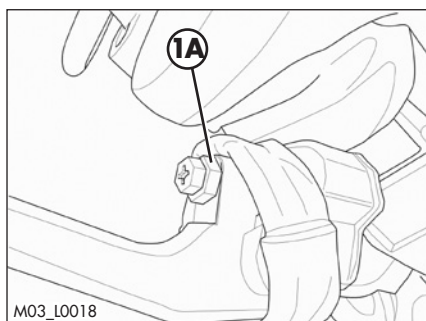
The home position of brake lever **2** can be adjusted by means of screw **1**.



 Warning! Once the adjustment has been made, tighten the locknut **1A**.

 Warning! Do not remove the locknut for any reason **1A**.

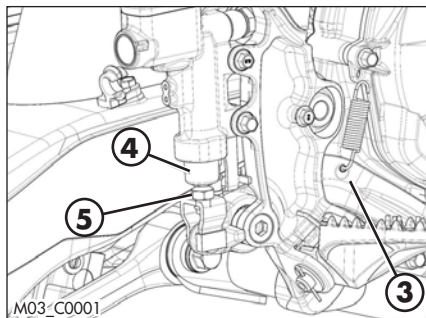

REAR BRAKE

The home position of brake pedal **3** can be altered by turning adjusting screw **5** after loosening the counternut located under dust cap **4**. Loosen the counternut and turn the adjusting screw until the desired height is obtained. Retighten the counternut after completing the operation.

CLUTCH

The adjustment screw **6** allows adjustment of the distance of lever **7** from the knob. The empty run is recovered automatically.

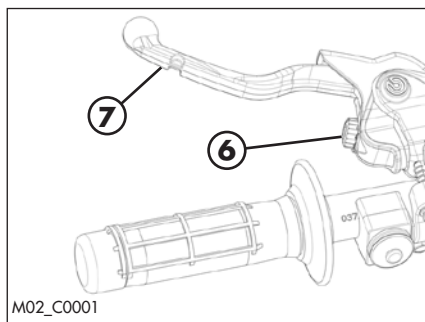

ADJUSTMENT OF GAS CLEARANCE

The throttle control cable should always have a 3-5 mm play. In addition, the idle speed should not change when the handlebars are fully rotated to the left or right. Push back protective cap **1**. To open the control, loosen the locknut **2** and turn the adjustment screw **3** appropriately. Tighten the locknut. To close, loosen the locknut **4** and turn the adjustment screw **5** appropriately. After adjustment, always check the smoothness of the throttle control grip.

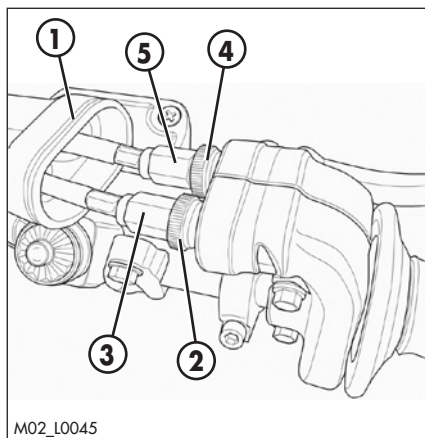

IDLE ADJUSTMENT

The minimum speed is controlled directly by the electronic control unit. Any manual adjustment is not allowed.



WARNING! Do not modify the indicated screw for any reason. Modifying the position of this screw may cause abnormal response behaviour and engine operation. Moving the indicated screw, in terms of the warranty, is considered tampering.

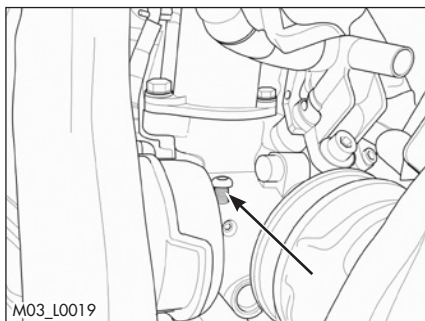

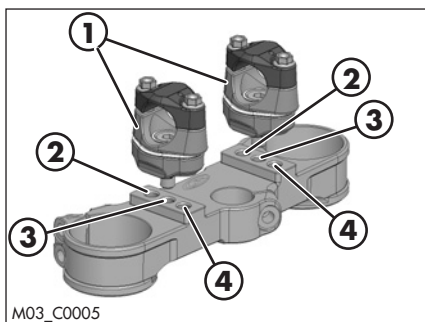

HANDLEBAR ADJUSTMENT

U-BOLT POSITION ADJUSTMENT

The lower bracket **1** can be mounted on the holes nr. **2**, **3** or **4** respectively.

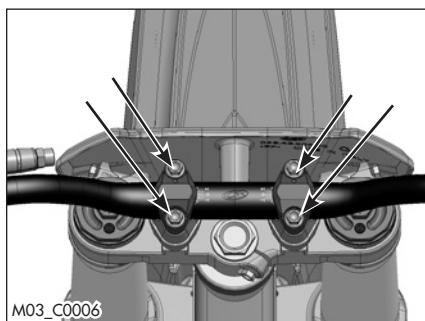

To adjust the position of the u-bolt remove the screws shown in the figure.

Remove the handlebar.

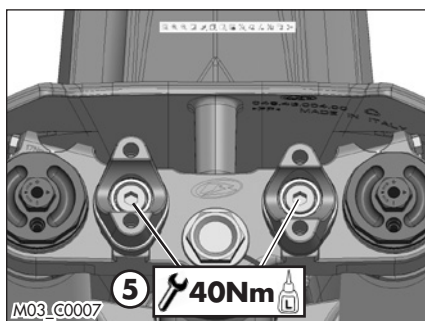

Remove the screws **5**.

Position the U-bolt as required.

At the end refit the screws **5** after the application of thread lock fluid and tighten to the torque indicated.

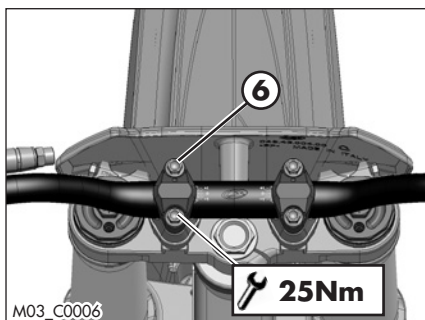

Apply the handlebar.

Apply the top u-bolt.

Refit the screws **6**. Tighten to the torque indicated.

NOTE: First, position the side of the U-bolt indicated with a dot and tighten to the specified torque. Then, perform the tightening on the other side as well.

ADJUSTMENT OF THE HANDLEBAR POSITION

The handlebar can be adjusted by rotating it back and forth.

To adjust the handlebar loosen screws **1**.

Position the handlebar according to requirements.

Tighten to the torque indicated.

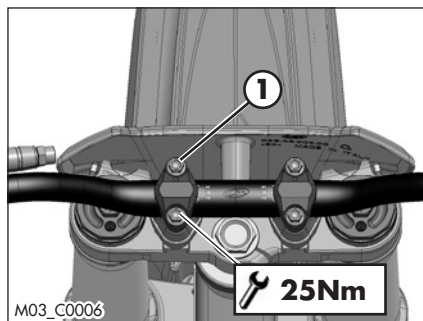

ADJUSTING FORK

ADJUSTING THE REBOUND DAMPER

The hydraulic rebound damper determines the behaviour of the telescopic fork during extension and can be adjusted by means of knob **A**. Turning the screw clockwise (towards **H**) increases the action of the rebound damper; turning it anticlockwise (towards **S**) decreases the action of the rebound damper.

For standard calibration, refer to page 11.

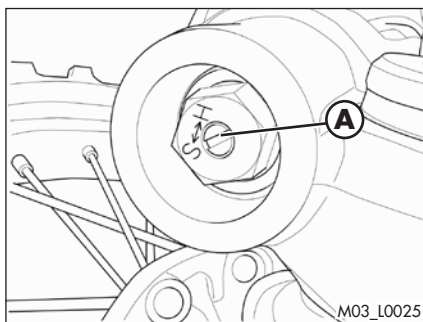

ADJUSTING THE COMPRESSION DAMPER

Hydraulic compression adjuster **B** is used to manage the ability of the fork to absorb a shock. The adjuster closes by moving the control towards the **H sign**, thus increasing the braking effect; the adjuster opens by moving the control towards the **S sign**, thus decreasing the braking effect.

For standard calibration, refer to page 11.

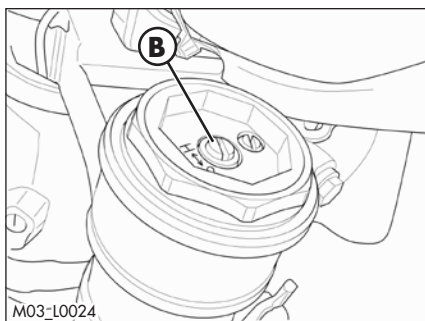

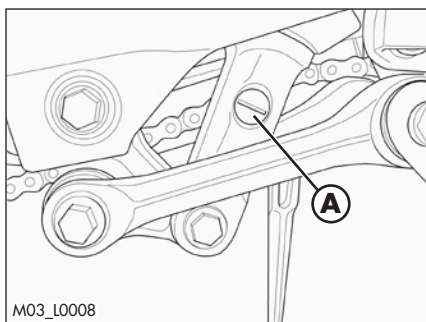

SHOCK ABSORBER

ADJUSTING THE REBOUND DAMPER

Turn screw **A** to adjust the hydraulic rebound damper.

Turning the screw anticlockwise (out) decreases the damping effect.

For standard setting, refer to page 11.

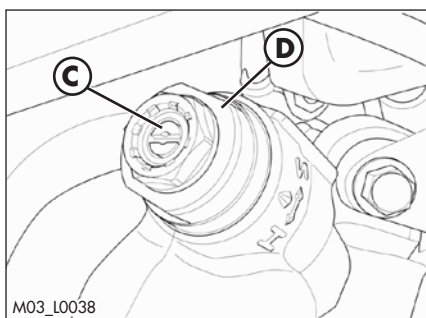

ADJUSTING THE HYDRAULIC COMPRESSION DAMPER (HIGH AND LOW SPEEDS)

Adjustment for low compression speed:

- Using a screwdriver, loosen screw **C** by turning it clockwise to increase the hydraulic compression damper.

For standard setting, refer to page 11.

Adjustment for high compression speed:

- Turn knob **D** anticlockwise to decrease the hydraulic compression damper.

For standard setting, refer to page 11.

WARNING:

Starting from the standard position, turn the knob anticlockwise (with a closing action), the center screw will have an integral movement, then will rotate with the knob.

For standard setting, refer to page 11.

ADJUSTING THE SPRING PRELOAD

Loosen counter-ring **E**, rotate ring **F** clockwise to increase the spring preload (and consequently the shock absorber preload) or anticlockwise to decrease it. After obtaining the desired preload, turn counter-ring **E** until it stops against adjusting ring **F**.

For standard setting, refer to page 11.

NOTE: for the handling of ring nuts use the specific wrench provided in the standard tool kit shown in the figure.

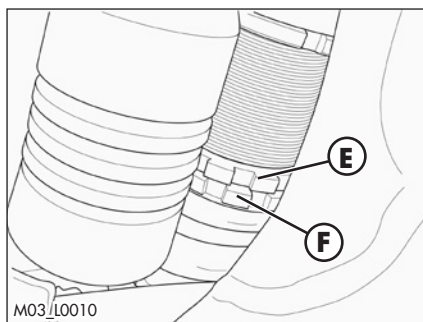

STATIC SAG LOAD TEST

To verify the static sag of the shock absorber proceed as follows:

- Place the motorcycle on the work stand.
- Measure the vertical distance between the rear wheel axle and a reference point on the rear fairings.
- Write down the dimension H_1 .
- Remove the work stand.
- Keep the motorcycle in vertical position and measure again the distance between the wheel axle and the reference point previously established.
- Write down the dimension H_2 .

Verify that the value of the static compression $X = H_1 - H_2$ matches the one shown on page 11. Otherwise, perform the adjustment of the spring preload as described above.

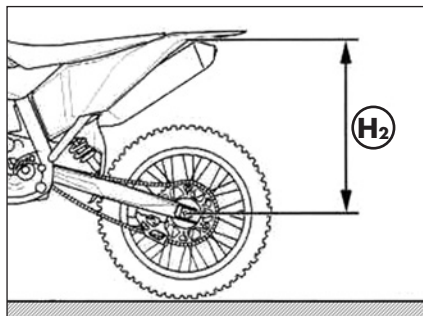
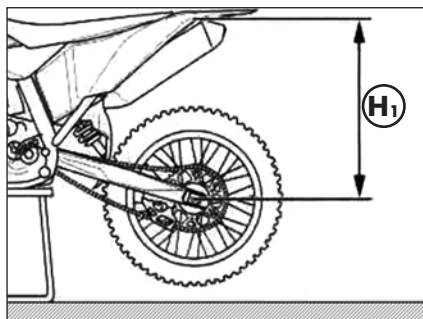

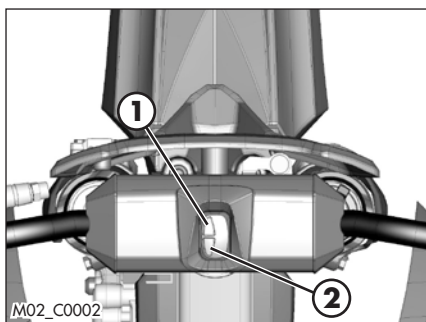

ENGINE MAPPING ADJUSTMENT AND TRACTION CONTROL ACTIVATION

- The top button **1** is the engine adjustment map switch: map white light for wet ground, map blue light for dry ground.
- The lower button **2** is traction control: if activated, the warning light with the TC symbol lights up yellow.

CHAPTER 4 CHECKS AND MAINTENANCE

CONTENTS

Engine oil.....	32
Check the level	32
Replacement	32
Gearbox oil	34
Check the level	34
Replacement	34
Liquid coolant.....	35
Check the level	35
Replacement	36
Air filter	38
Air filter cleaning.....	39
Spark plug	41
Front brake.....	42
Check the level of the front brake fluid	42
Restoring the level of the front brake fluid	42
Bleeding the front brake	43
Front brake lining control	44
Brake disc thickness control	44
Rear brake	45
Check the level of the rear brake fluid	45
Restoring the level of the rear brake fluid	45
Bleeding the rear brake	46
Rear brake lining control	47
Brake disc thickness control	47
Clutch control	48
Check the level	48
Bleeding	49
Check and adjusting of steering play.....	50
Fork.....	51
Front wheel	51
Tightening	51
Tyres.....	52
Rear suspension leverage.....	52
Chain	53
Check and adjust tightening chain.....	53
Check for chain wear	54
Battery.....	55
Battery removal.....	55
Battery assembly	56
Inactivity	56
Charging the battery	57
Fuses	57
Cleaning the vehicle	58
General precautions	58
Electrical connector maintenance	59
Control unit connector.....	59
Air pressure and temperature sensor	60
Prolonged inactivity	61
Scheduled maintenance vehicle	62
Tightening torque overview	64

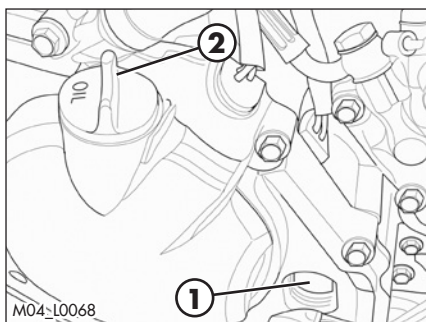

ENGINE OIL

CHECK THE LEVEL

- 1) Keep the vehicle in vertical position relative to the ground.
- 2) Position the drive on a flat base ensuring stability.
- 3) Start the engine and keep it running for about 2 minutes.
- 4) Keeping the engine idling, check that the oil level reach middle of the of the inspection window **1**.
- 5) If the level is below the edge of the window, switch off the engine and top up through the filler hole **2**. Load oil until it reaches the upper edge of the window.
- 6) Close the filling hole with the plug **2** and repeat steps 3, 4 and 5 until the condition in step 4 is satisfied.

Use the oil indicated on page 13 in the "Recommended lubricants and liquids" table.

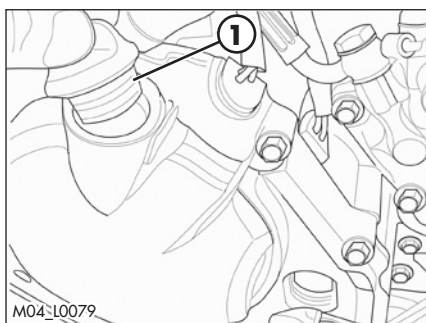

REPLACEMENT

Always perform the replacement when engine is hot:

- Position the drive on a flat base ensuring stability.
- Place a container under the engine.



WARNING:

Hot oil can cause severe burns!

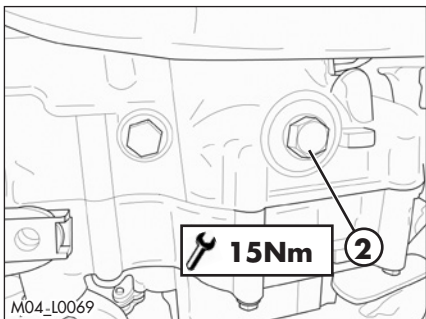

- Unscrew filler plug **1** and drain plug **2**.
- Remove the wire mesh filter.
- Drain all the oil from the crankcase.
- Thoroughly clean the drain plug, the wire mesh filter and the sealing surfaces.
- Mount the wire mesh filter and the drain plug.
- Tighten to the torque indicated.

To change the paper filter, remove the oil tap from engine unscrewing the two screws **3**. Using special seeger ring pliers, pull the paper oil filter.

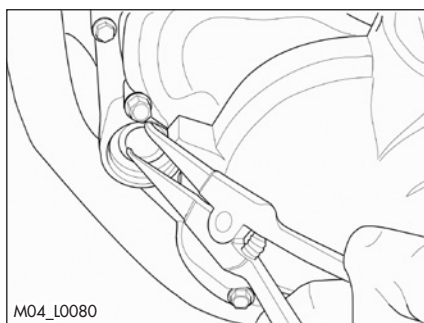
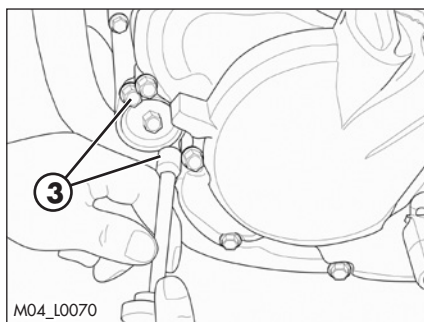

Mount the new paper filter, close the oil tap to engine, tighten the screws at 10 Nm.

Pour in the quantity of liquid indicated on page 10.

Use the oil indicated on page 13 in the "Recommended lubricants and liquids" table.

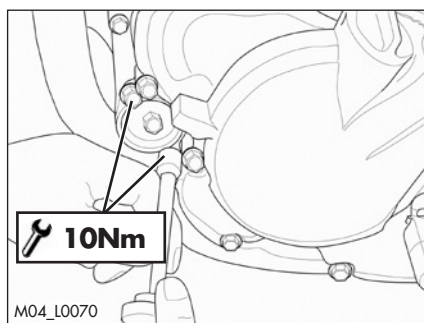

- Screw on filler cap **1** again.
- Check the oil level as described in paragraph "Check the level" (page 32).

WARNING:

Hot oil can cause severe burns!

ATTENTION:

Dispose of used oil in compliance with the regulations in force.

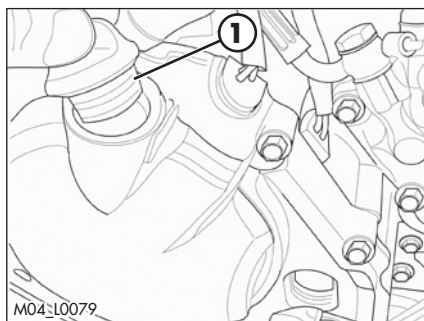

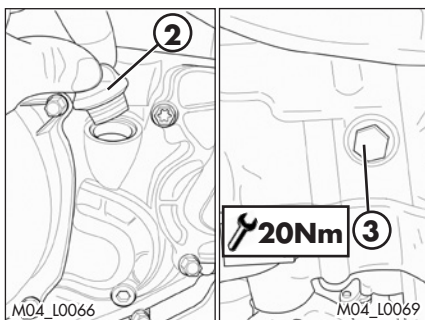
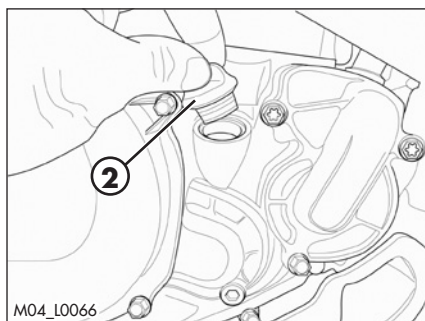
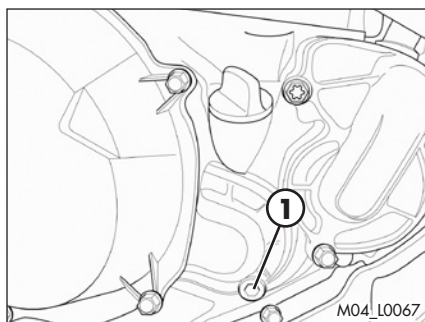

GEARBOX OIL

CHECK THE LEVEL

Hold the vehicle upright.
Position the drive on a flat base ensuring stability.

Remove the inspection cap **1**.

The oil level must arrive to the lower edge of check hole.

In contrary case restore the oil level through cap **2**.

The inspection cap is **ONLY** to check the oil level. For the oil drain, refer to the paragraph Replacement on page 34.

Use the oil indicated on page 13 in the "Recommended lubricants and liquids" table.

REPLACEMENT

Always perform the replacement when engine is hot:

- Position the drive on a flat base ensuring stability.

- Place a container under the engine.



WARNING:

Hot oil can cause severe burns!

- Unscrew filler plug **2** and drain plug **3**.
- Drain all the oil from the crankcase.
- Apply the cap **3** and tighten up to the specified torque.

Pour in the quantity of liquid indicated on page 10.

Use the oil indicated on page 13 in the "Recommended lubricants and liquids" table.

Close plug **2**.

WARNING:

Hot oil can cause severe burns!

ATTENTION:

Dispose of used oil in compliance with the regulations in force.

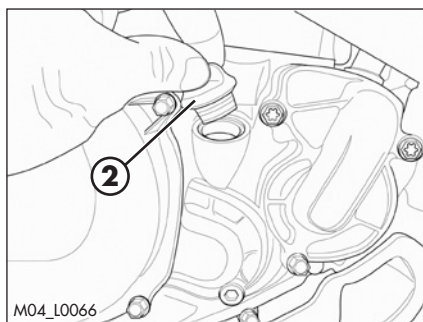

LIQUID COOLANT

CHECK THE LEVEL



WARNING: Never unscrew the filler cap of the radiator when the engine is hot. Danger of burning!

Keep the vehicle in vertical position relative to the ground.

The level of the coolant must be checked when the engine is cold. Use the following procedure:

- Unscrew cap **1** and ensure that the liquid is visible in the lower portion of the loading tube.
- In the case in which the liquid is not visible proceed topping up.
- At the end of operation refit the filler cap.

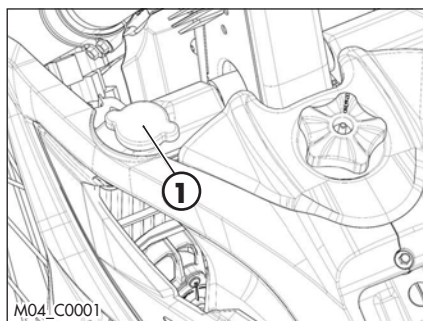

Use the liquid coolant indicated on page 13 in the "Recommended lubricants and liquids" table.



WARNING: Never unscrew the filler cap of the radiator when the engine is hot. Danger of burning!



WARNING:

Wear appropriate protective clothing and protection gloves.



Keep coolant out of reach of children.



Avoid any direct contact of the coolant with skin, eyes or clothing. If this happens:

- with the eyes, rinse immediately with plenty of water and seek medical advice;
- with skin, Immediately clean contaminated areas with soap and water Change clothing that is contaminated with coolant.

If coolant is swallowed, contact a doctor immediately.

REPLACEMENT

Keep the vehicle in vertical position relative to the ground.

Replacement of the coolant must take place when the engine is cold.

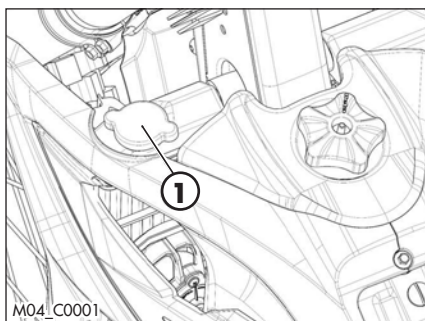

- Unscrew cap **1**.

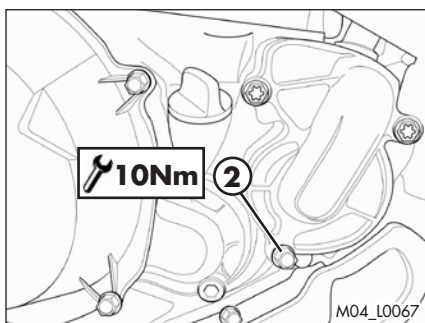

- Place a container under screw **2**.
- Unscrew the screw **2**.
- Drain the liquid.
- Tighten screw **2** applying the specific washer.
- Top up.
- Reapply the loading cap.

The amounts of liquid are shown on page 10.

Use the liquid indicated on page 13 in the "Recommended lubricants and liquids" table.

**WARNING:**

Never unscrew the filler cap of the radiator when the engine is hot. Danger of burning!

**WARNING:**

Wear appropriate protective clothing and protection gloves.



Keep coolant out of reach of children.



Avoid any direct contact of the coolant with skin, eyes or clothing. If this happens:

- with the eyes, rinse immediately with plenty of water and seek medical advice.
- with skin, Immediately clean contaminated areas with soap and water Change clothing that is contaminated with coolant.

If coolant is swallowed, contact a doctor immediately.

AIR FILTER

Check after every ride.

To access the filter:

- Remove the filter cover panel (page 69).

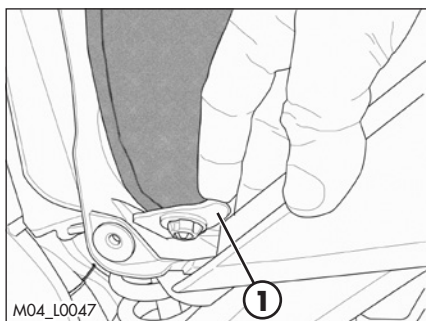

- Release filter fastener **1**

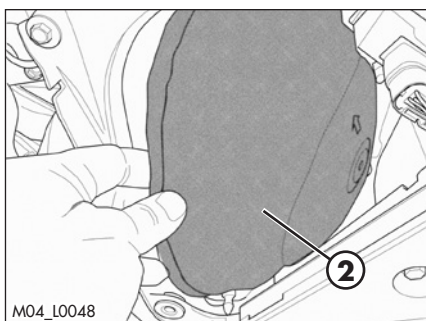

- Pull out air filter **2**

Reassemble by performing the operations in reverse order.





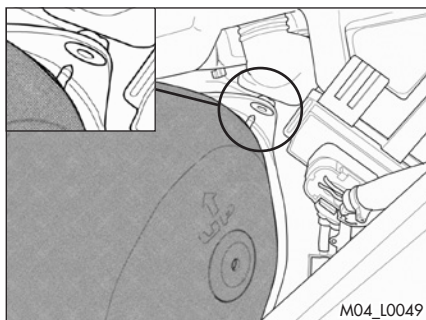

WARNING:

After every intervention, check that nothing has been left inside the filter box.



WARNING!

When re-inserting the filter, be careful that the pin on the filter cage is properly engaged into the specific housing.

-  **WARNING:**
Do not clean the filter with gasoline or petrol.
-  **NOTE:**
If the filter is damaged, replace it immediately.
To replace, contact authorised Beta-motor customer service.
-  **WARNING:**
Never use the vehicle if the air filter is not in place. The infiltration of dust and dirt can cause damage and considerable wear.
-  **WARNING:**
After every intervention, check that nothing has been left inside the filter box.

AIR FILTER CLEANING

- Thoroughly wash the filter with water and soap.
- Dry the filter.
- Wet the filter with filter oil and then remove the excess oil to prevent it from dripping.
- If necessary also clean the interior of the filter box.

Apply the sponge filter element to the cage with care:

- to make to correspond the sign UP of the filter with the coding indicated on the cage.

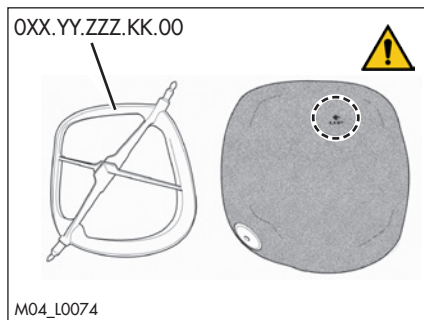

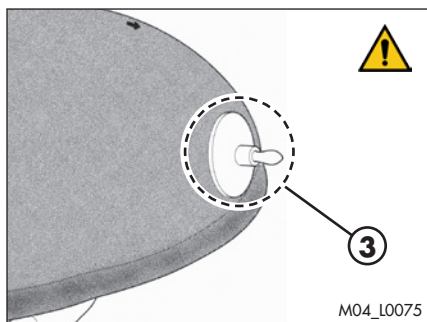

- To completely insert the rungs **3** of the cage into the filter seats.

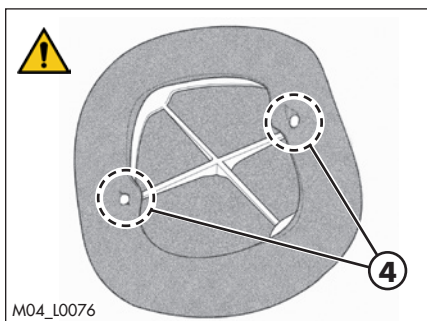

- To hook the inside edges of the filter with the correspondents grafts **4** found on the cage.

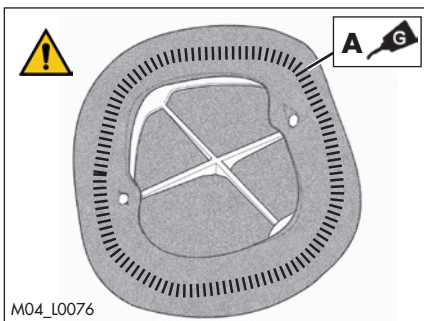

Note: before refitting the filter to the vehicle is recommended to apply a long-term grease in the area **A**.

SPARK PLUG

Keeping the spark plug in good condition will reduce fuel consumption and increase engine performance.

To accede to spark plug, is necessary to take off saddle (page 68) and the fuel tank (page 72).

Examine the distance between the electrodes with a feeler. This distance should be from $0,5 \div 0,6$ mm. If it is not, it may be corrected by bending the earth electrode.

Check as well that there are no cracks in the insulation or corroded electrodes. If so, replace immediately.

When replacing the spark plug, screw it in by hand until it stops, then tighten with a wrench.



WARNING:

Do not check while the engine is hot.

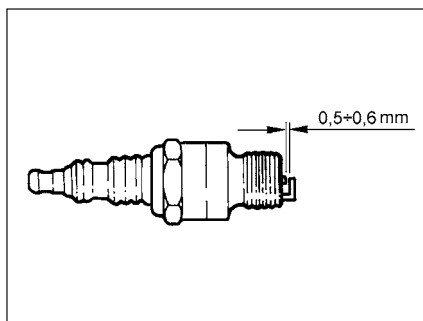

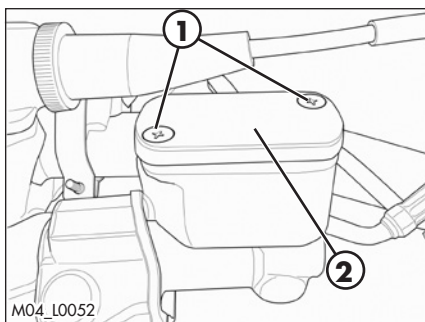
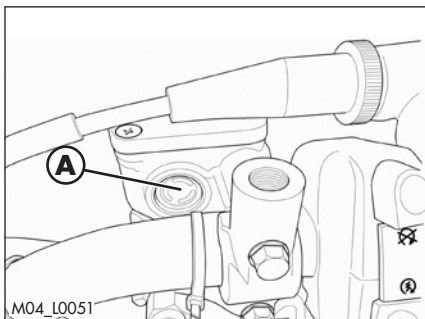

FRONT BRAKE

CHECK THE LEVEL OF THE FRONT BRAKE FLUID

Check the level of the brake fluid through sight **A**. The level of the fluid should never fall below the mark in the sight.

RESTORING THE LEVEL OF THE FRONT BRAKE FLUID

To restore the level of the brake fluid, loosen the two screws **1**, lift cap **2** and add brake fluid until its level is 5 mm below the upper rim of the reservoir.

Use the liquid indicated on page 13 in the "Recommended lubricants and liquids" table.



WARNING:

The brake fluid is extremely corrosive. Take care not to spill it on the paintwork.



Wear appropriate protective clothing and protection gloves.



Keep coolant out of reach of children.



WARNING: Avoid any direct contact of the liquid with skin, eyes or clothing. If this happens:

- with the eyes, rinse immediately with plenty of water and seek medical advice.
- with skin, immediately clean contaminated areas with soap and water. Change clothing that is contaminated with liquid.

If liquid is swallowed, contact a doctor immediately.

BLEEDING THE FRONT BRAKE

To bleed air from the front brake circuit, proceed as follows:

- Remove the rubber cap **1** from the valve **2**.
- Open the sump cap.
- Place one end of a small transparent tube into the valve **2**, and the other end inside a container.
- Pump with the brake lever 2/3 times and keep the lever pressed.
- Unscrew the valve and let the oil drain.
- If are still visible in the tube repeat above operation until obtaining a continuous outflow of oil within no air bubbles.
- Close the valve and release the lever.

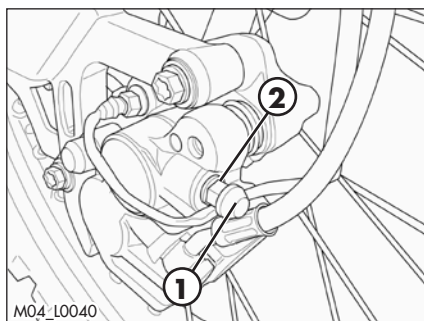

NOTE:

during this procedure, continuously top up the brake pump thank to replace the oil that is out flowing.

- Remove the tube.
- Replace the rubber cap.
- Close the oil reservoir cap.

Use the liquid indicated on page 13 in the "Recommended lubricants and liquids" table.



WARNING:

The brake fluid is extremely corrosive. Take care not to spill it on the paintwork.



Wear appropriate protective clothing and protection gloves.



Keep coolant out of reach of children.



WARNING: Avoid any direct contact of the liquid with skin, eyes or clothing. If this happens:

- with the eyes, rinse immediately with plenty of water and seek medical advice.
- with skin, immediately clean contaminated areas with soap and water. Change clothing that is contaminated with liquid.

If liquid is swallowed, contact a doctor immediately.

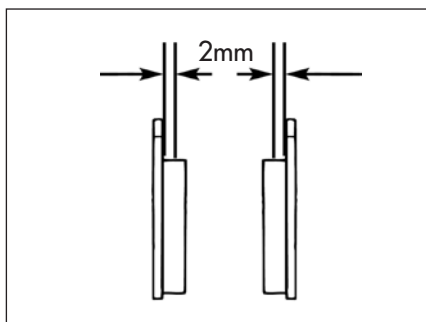

FRONT BRAKE LINING CONTROL

In order to verify the wear condition of front brake is enough to view the caliper from the bottom, where is possible to glimpse the brake lining tails which will have to show a brake of 2 mm in thickness. If the stratum is lesser let's start replacing them.

NOTE:

Perform the check according to the times shown in the table on page 62.

To replace, contact authorised Betamotor customer service.

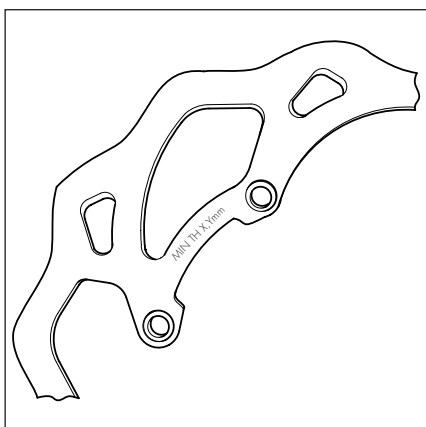

BRAKE DISC THICKNESS CONTROL

Periodically verify disc condition. In case signs of damage, veins, or deformations are present, proceed with replacement. Verify disc thickness. The minimum thickness is engraved on the disc.

Once the limit is in proximity or has been reached, proceed with brake disc replacement.

For replacement, contact an authorised Betamotor after-sales service centre.

REAR BRAKE

CHECK THE LEVEL OF THE REAR BRAKE FLUID

Check the level of the brake fluid through sight **A**. The level of the fluid should never fall below the mark in the sight.

RESTORING THE LEVEL OF THE REAR BRAKE FLUID

To restore the oil level, top up by means of oil filler cap **1**.

Use the liquid indicated on page 13 in the "Recommended lubricants and liquids" table.



WARNING:

The brake fluid is extremely corrosive. Take care not to spill it on the paintwork.



Wear appropriate protective clothing and protection gloves.



Keep coolant out of reach of children.



WARNING: Avoid any direct contact of the liquid with skin, eyes or clothing. If this happens:

- with the eyes, rinse immediately with plenty of water and seek medical advice.
- with skin, immediately clean contaminated areas with soap and water. Change clothing that is contaminated with liquid.

If liquid is swallowed, contact a doctor immediately.

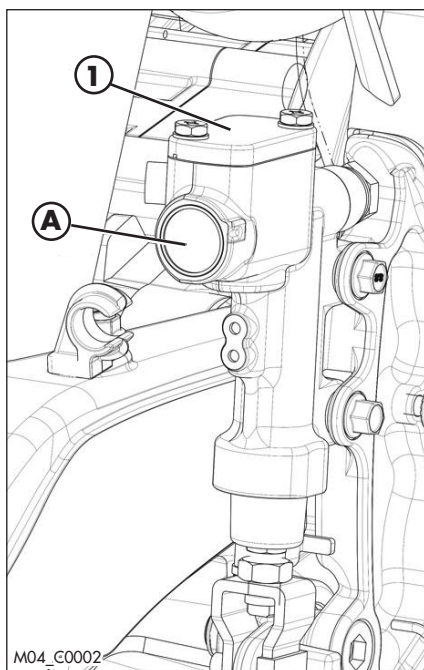

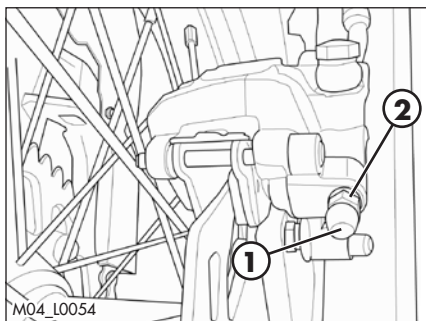

BLEEDING THE REAR BRAKE

To bleed air from the rear brake circuit, proceed as follows:

- Remove the rubber cap **1** from the valve **2**.
- Open the sump cap.
- Place one end of a small transparent tube into the valve **2**, and the other end inside a container.
- Pump with the brake lever 2/3 times and keep the pedal pressed.
- Unscrew the valve and let the oil drain.
- If air is still visible in the tube repeat above operation until obtaining a continuous outflow of oil without air bubbles.
- Close the valve and release the lever.

NOTE:

During this procedure, continuously top up the brake pump tank to replace the oil that is out flowing.

- Remove the tube.
- Replace the rubber cap.
- Close the oil reservoir cap.

Use the liquid indicated on page 13 in the "Recommended lubricants and liquids" table.



WARNING:

The brake fluid is extremely corrosive. Take care not to spill it on the paintwork.



Wear appropriate protective clothing and protection gloves.



Keep coolant out of reach of children.



WARNING: Avoid any direct contact of the liquid with skin, eyes or clothing.
If this happens:

- with the eyes, rinse immediately with plenty of water and seek medical advice.
- with skin, immediately clean contaminated areas with soap and water. Change clothing that is contaminated with liquid.

If liquid is swallowed, contact a doctor immediately.

REAR BRAKE LINING CONTROL

In order to verify the wear condition of front brake is enough to view the caliper from the bottom, where is possible to glimpse the brake lining tails which will have to show a brake of 2 mm in thickness. If the stratum is lesser let's start replacing them.

NOTE:

Perform the check according to the times shown in the table on page 62.

To replace, contact authorised Betamotor customer service.

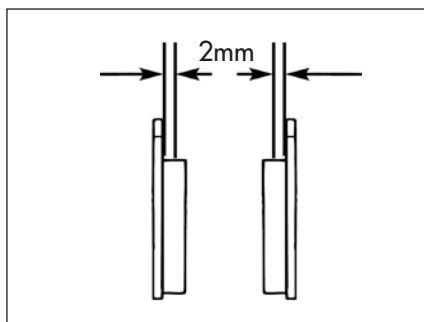

BRAKE DISC THICKNESS CONTROL

Periodically verify disc condition. In case signs of damage, veins, or deformations are present, proceed with replacement. Verify disc thickness. The minimum thickness is engraved on the disc.

Once the limit is in proximity or has been reached, proceed with brake disc replacement.

For replacement, contact an authorised Betamotor after-sales service centre.

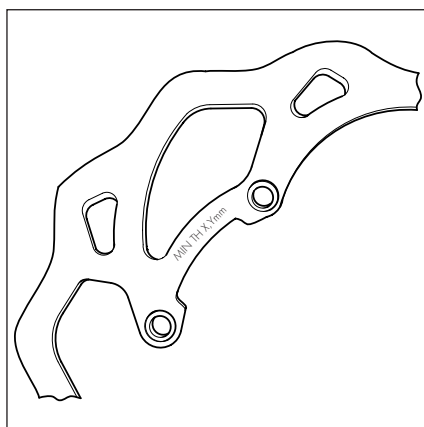

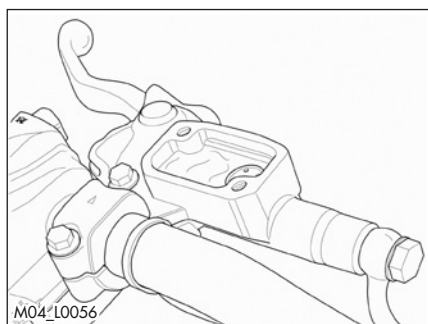
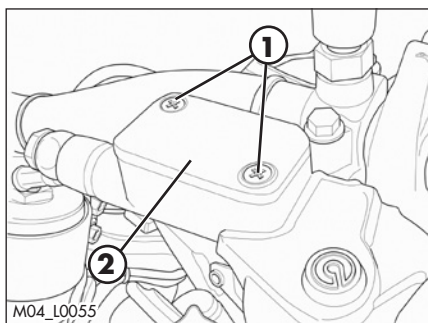

CLUTCH CONTROL

CHECK THE LEVEL

To check the oil level in the clutch pump, first remove cover **2**.

Remove the two screws **1** and take off cover **2** together with the rubber bellows. With the clutch pump in a horizontal position, the level of the oil should be 5 mm below the upper rim.

In the case where the level is lower than specified top up.

Use the liquid indicated on page 1.3 in the "Recommended lubricants and liquids" table.



WARNING:

The clutch fluid is extremely corrosive. Take care not to spill it on the paintwork.



Wear appropriate protective clothing and protection gloves.



Keep coolant out of reach of children.



WARNING: Avoid any direct contact of the liquid with skin, eyes or clothing. If this happens:

- with the eyes, rinse immediately with plenty of water and seek medical advice.
- with skin, immediately clean contaminated areas with soap and water. Change clothing that is contaminated with liquid.

If liquid is swallowed, contact a doctor immediately.

BLEEDING

To bleed air from the clutch pump, proceed as follows:

- Remove the rubber cap **1** from the valve **2**.
- Open the sump cap.
- Place one end of a small transparent tube into the valve **2**, and the other end inside a container.
- Pump with the clutch lever 2/3 times and keep the lever pressed.
- Unscrew the valve and let the oil drain.
- If are still visible in the tube repeat above operation until obtaining a continuous outflow of oil within no air bubbles.
- Close the valve and release the lever.

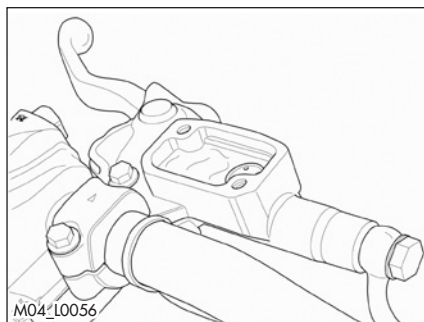
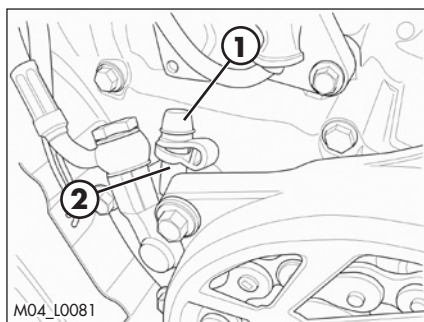

NOTE:

During this procedure, continuously top up the pump tank to replace the liquid that is out flowing.

- Remove the tube.
- Replace the rubber cap.

Use the liquid indicated on page 13 in the "Recommended lubricants and liquids" table.



WARNING:

The clutch fluid is extremely corrosive. Take care not to spill it on the paintwork.



Wear appropriate protective clothing and protection gloves.



Keep coolant out of reach of children.



WARNING: Avoid any direct contact of the liquid with skin, eyes or clothing. If this happens:

- with the eyes, rinse immediately with plenty of water and seek medical advice.
- with skin, immediately clean contaminated areas with soap and water. Change clothing that is contaminated with liquid.

If liquid is swallowed, contact a doctor immediately.

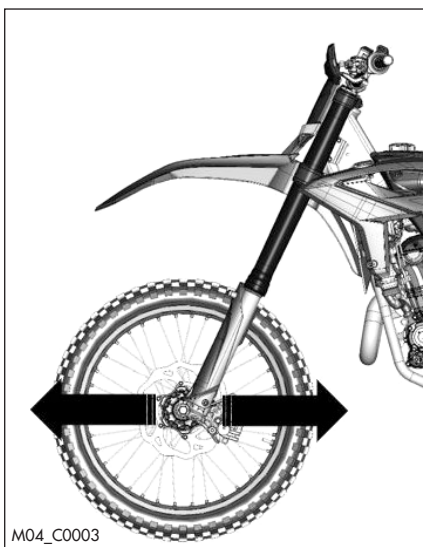

CHECK AND ADJUSTING OF STEERING PLAY

Periodically check the play in the steering sleeve by moving the fork back and forth as shown in the figure. Whenever you feel play, adjust as described below:

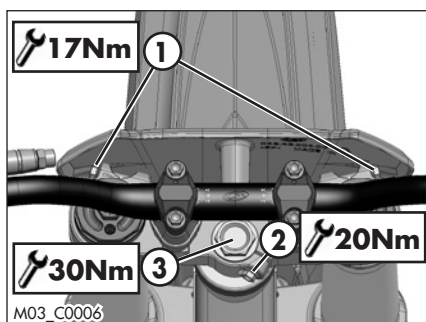

- Loosen the screws **1**
- Loosen the screw **2**
- Reduce the play by turning nut **3**

Tighten nut **3** to the indicated torque and make sure the steering wheel has no slack and moves freely, then proceed with tightening screws **1** and **2** to the indicated torque.



WARNING:

Tightening of the screws should be carried out by adjusting the torque wrench to the stability torque with repeated tightening until stability torque has been achieved.

FORK

To maintenance refer at an authorized service centre Betamotor.

To check the tightening torques see as shown in the figure.



WARNING:

Tightening of the screws should be carried out by adjusting the torque wrench to the stability torque with repeated tightening until stability torque has been achieved.

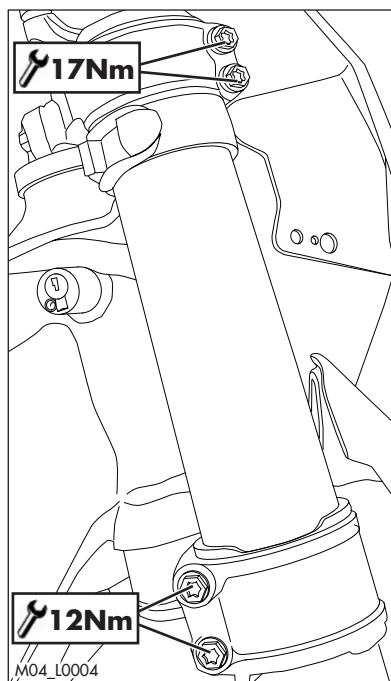

FRONT WHEEL

TIGHTENING

Following removal of the wheel:

Compress and release the fork 3-4 times.

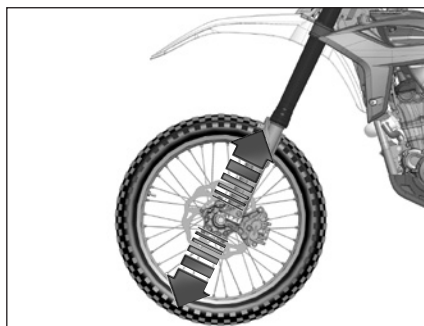

Tighten the wheel bolt and the screws of the foot-legs.



WARNING:

Tightening of the screws should be carried out by adjusting the torque wrench to the stability torque with repeated tightening until stability torque has been achieved.

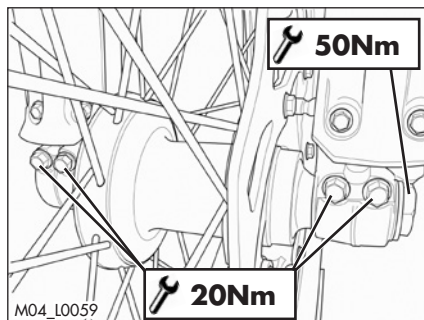

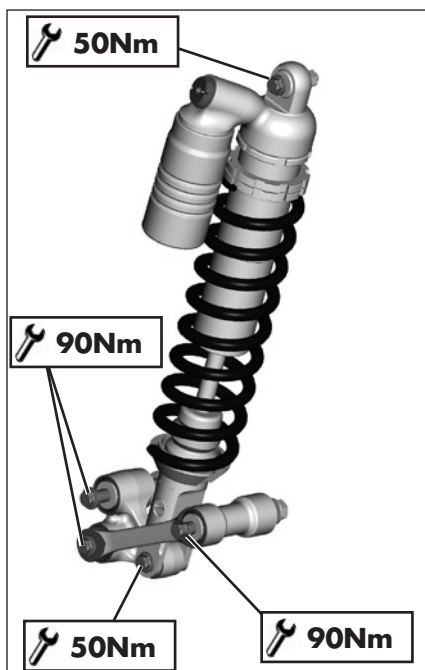

REAR SUSPENSION LEVERAGE

In order to guarantee optimal operation and duration over time of the progressive leverage of the rear suspension, it is recommended to periodically check correct tightness of nuts and bolts.

Verify that suspension nuts and bolts are at the indicated torque.

TYRES

Only fit tyres approved by BETAMOTOR.

Unsuitable tyres can adversely affect the road holding of the vehicle.

- To protect your safety, immediately replace any damaged tyres.
- Slick tyres adversely affect the road holding of the vehicle, especially on wet roads and in off-road riding.
- Insufficient pressure results in abnormal wear and overheating of the tyres.
- The front and rear tyres must have the same tread design.
- Always measure the inflating pressures when the tyres are cold.
- Keep the tyre pressures within the prescribed range.

CHAIN

Checking the drive chain periodically to ensure longer chain life. Always keep it lubricated and clean of deposited dirt.

Take special care in preventing the lubricant from coming into contact with the rear tyre or brake disc, otherwise the tyre grip and the action of the brake would be greatly reduced, making it very difficult to control the vehicle.

CHECK AND ADJUST TIGHTENING CHAIN

Hold the vehicle upright on the ground on a flat base ensuring stability.

The chain clearance must comply with the measure indicated. Tension the chain if the clearance exceeds the indicated value.

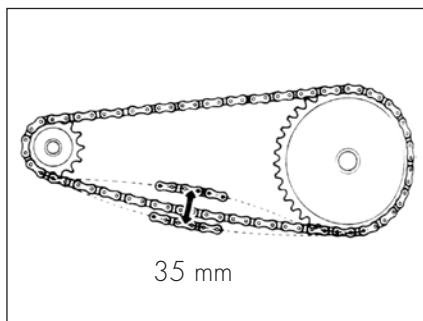

- Loosen the pin **1**.

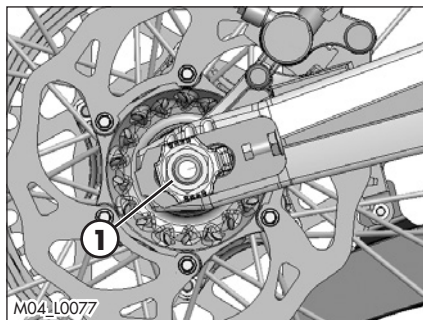

- Loosen counternuts **A** on either side of the fork.
- Turn adjusting screws **B** on either side until the desired chain tension is obtained.
- Tighten counternuts **A** on either side of the fork.

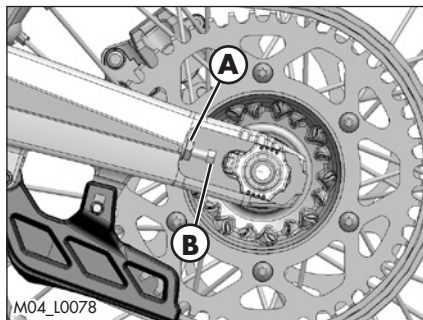

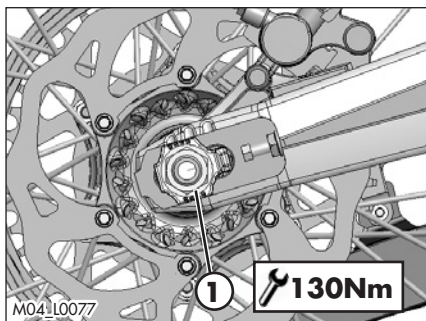

- Tighten the pin **1** to the torque indicated.

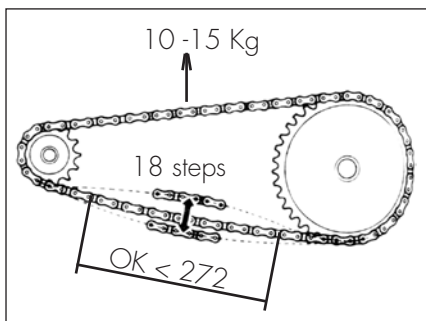

CHECK FOR CHAIN WEAR

Shift into neutral, pull up the upper stretch of the chain with a force of 10 - 15 kg (see figure). Measure the length of 18 links on the lower stretch of the chain. If the length is ≥ 272 mm, replace the chain. Chains do not always wear evenly. For this reason it is important that the measurement is taken at different points along the chain.

When fitting a new chain, be sure to replace the chainring and sprocket as well. New chains wear more quickly if fitted on old and worn sprockets. After replacing the chain, adjust its tension as described on page 13.

BATTERY

Battery is located under the saddle and requires no maintenance.

Keep the battery terminals clean. If necessary, protect them with a thin film of acid-free grease.



WARNING:

The battery contains hazardous substances:

- Keep the batterie out of the reach of children.



- Keep sparks and open flames away from the battery.



- Charge the battery only in well-ventilated areas, keeping it away from flammable materials. Use only chargers suitable for charging lithium-ion batteries.



- Do not attempt to charge fully exhausted batteries with a voltage lower than the minimum 9V. In this case, dispose of the battery according to applicable regulations.



- Do not remove the protections.

- When installing the battery, be sure to observe the polarity of the terminals.

BATTERY REMOVAL

Shut off all electrical users and stop the engine.

Remove the saddle (page 68).

FIRST remove the cap **1** of the negative pole and disconnect the negative lug **2** (black) from the negative pole.

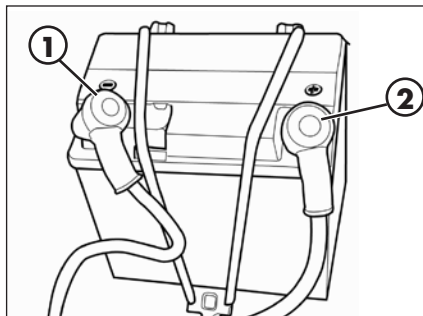

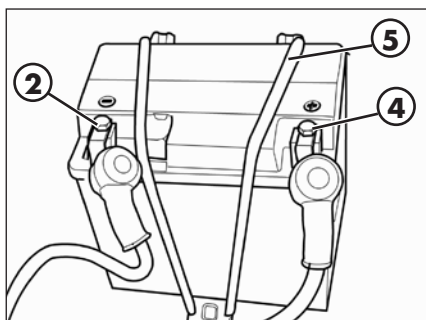

THEN remove the cap of the positive pole **3** and disconnect the positive lug **4** (red) from the positive pole (+).

Release the rubber band **5**.

Remove the battery.

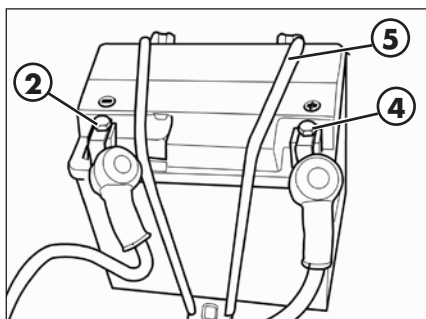

BATTERY ASSEMBLY

When fitting the battery, insert it with the terminals as shown in picture.

Reattach the rubber band **5**.

FIRST Connect the positive lug **4** (red) to the positive pole (+) of the battery by pushing the protective cap **3** in its position.

THEN secure the negative lug **2** (black) to the negative pole (-) of the battery by bringing the relative protective cap **1** in position.

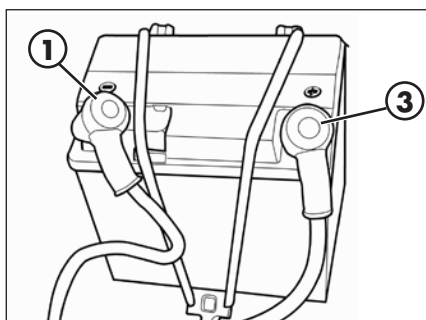

Refit the saddle (page 68).

INACTIVITY

If the vehicle is not going to be used for a long time:

- remove the battery (page 55)
- charge with an adequate charger (page 57)
- store the battery in a dry place. The ideal temperature for storing the lithium-ion battery is 20°C.

CHARGING THE BATTERY

Check the battery charge using a multi-meter:

- Voltage < 9V or "LOW":
 - Do NOT charge the battery
 - Replace the battery with a new equivalent one
- Voltage < 12.4V or "MED":
 - Charge the battery



Guidelines to charge the battery:



Use ONLY chargers suitable for charging lithium-ion batteries.

Maximum charging voltage: 14.4V

Maximum charging current: 3.0A

Maximum charge time: 12h

Recharge the battery regularly with a specific battery charger when the vehicle is not used for more than 6 months

Ideal temperature for charging lithium ion batteries: 20 °C.

FUSES

To access the fuse, remove the saddle (page 68).

Fuse **1**: in the event of a blown fuse, the vehicle does not start.

One spare fuse comes with the kit accompanying the vehicle.

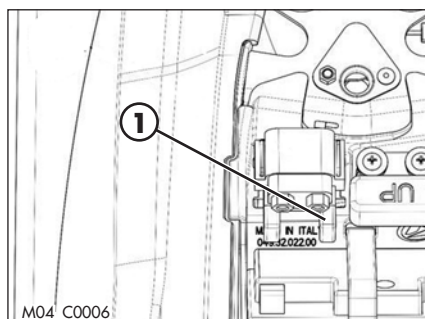



A blown fuse should only be replaced with another of the same type.

Should the new fuse also burn out when fitted, immediately contact a specialized BETAMOTOR dealer.

CLEANING THE VEHICLE

GENERAL PRECAUTIONS

-  **WARNING:** Do not clean your vehicle with a high-pressure device with a strong jet of water. Excessive pressure can reach electrical components, connectors, flexible cables, bearings, etc and can damage or destroy them.
-  **WARNING:** Wash motorbikes frequently with cold water that are used near the sea (salty air) and on roads subject to salt spreading in winter. Cover with a film of oil or silicone spray unpainted parts and the most exposed parts such as wheels, forks and swingarm. Do not treat rubber parts and brakes.

When cleaning, avoid direct exposure to sunlight.

Close off the exhaust system to prevent water from entering.

-  Avoid directing the jet of water onto the air filter box cover and the throttle body.

WASHING MODE



Use water jet to soften the dirt and mud accumulated on the paintwork, then remove them with a soft bodywork sponge soaked in water and shampoo. Subsequently rinse well with water, and dry with air and cloth or suede leather.

Detergents pollute water. Always wash the vehicle in areas equipped for collection and purification of the washing liquids.

AFTER WASHING

Proceed to the emptying of the filter box using the appropriate ventilation and drying.

After cleaning, ride a short distance until the engine reaches operating temperature.

-   **WARNING:** braking effect is reduced with wet brakes. Operate the brakes cautiously to allow them to dry.

Push back the handlebar control covers, so that water can evaporate.

When the bike is completely dry and cooled down, lubricate all moving parts.

Treat all plastic and painted components with non-aggressive detergents or products that are specific for the care of the motorcycle.

To prevent malfunction of the electrical system, treat electric contacts and switches with electrical contact spray.



ATTENTION: any oxidation of electrical contacts may result in serious malfunctioning to the power supply system.

Specifically, treat the battery poles as described on page 55 and pay particular attention to what is contained here below.

ELECTRICAL CONNECTOR MAINTENANCE

Disconnect the connectors listed below, blow compressed air on the connector both on the system and on the component side, and treat electrical contacts and switches with spray for electrical contacts.

CONTROL UNIT CONNECTOR

To access the control unit connector it is necessary to remove the air filter cover panel (page 69).

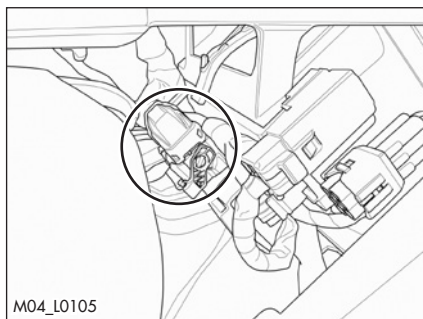

Then:

- press the lock device;
- rotate the safety device as shown;
- remove the connector;

For re-assembly, proceed opposite the above-mentioned order.



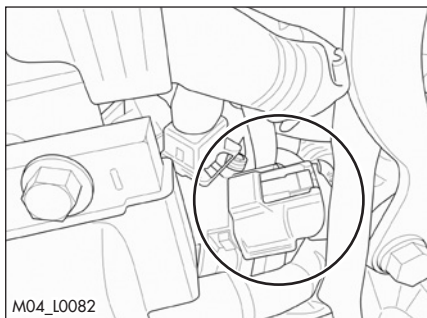

AIR PRESSURE AND TEMPERATURE SENSOR

Remove the tank (page 72).

The connector is positioned as indicated in figure.

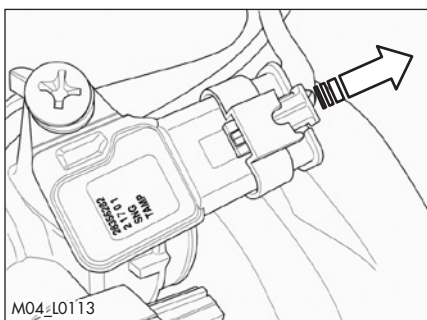

- 1) remove the safety catch following the direction of the arrow;
- 2) lift tab **1** and pull in the direction indicated by arrow **2**.

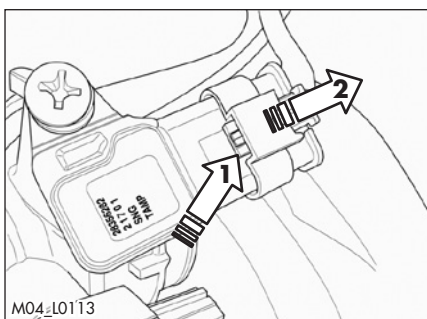

For re-assembly, proceed opposite the above-mentioned order.

Attention: at the end of the operation ensure that the connector is blocked.

PROLONGED INACTIVITY

A few simple operations should be performed to keep the vehicle in good condition whenever it is to remain inactive for a long period (e.g. during the winter):

- Thoroughly clean the vehicle.
- Reduce the tyre pressures by approximately 30 percent, and if possible raise the tyres off the ground.
- Cover the unpainted parts, excepting the brakes and the rubber parts, with a film of oil or spray silicone.
- Remove the battery (page 55), and follow the instructions for inactivity (page 56) and recharging (page 57).
- Protect the vehicle with a non-waterproof sheet to protect from dust.

AFTER PROLONGED INACTIVITY

- Reinstall the battery.
- Restore the tyre inflating pressures.
- Check the tightening of all the screws having an important mechanical function.

SCHEDULED MAINTENANCE VEHICLE

WARNING! Register the maintenance operation on Betanet.

WARNING! After the first 100 Km (62 miles) of riding check the tightening of the following safety parts:

- Rear sprocket
- Pinion
- Brake discs
- Brake pedal
- Brake calipers

Engine		Running-in	Coupon 1 - 10 hours	Coupon 2 - 20 hours	Coupon 3 - 30 hours	Coupon 4 - 40 hours	Coupon 5 - 50 hours	Coupon 6 - 60 hours	Coupon 7 - 70 hours	Coupon 8 - 80 hours	After every ride
	Engine oil	S	S	S	S	S	S	S	S	S	C
	Gear and clutch oil	S	S	S	S	S	S	S	S	S	C
	Paper filter oil	S		S		S		S		S	
	Wire netting filter oil	P	P	P	P	P	P	P	P	P	
	Engine clamping screws	C	C	C	C	C	C	C	C	C	
	Head screws	T				C				C	
	Kick start and gearchange lever screws	C		C		C		C		C	
	Spark plug cap									S	C
	Spark plug					S				S	
	Breather pipe	C		C		C		C		C	
	Countershaft bearings										
	Crankshaft bearings									S	
	Connecting rod									S	
	Piston and segments					S				S	
	Cylinder					C				C	
	Surface appearance of the cams					C				C	
	Valve clearance	C		C		C		C		C	
	Valves					C				C	
	Valve guide wear					C				C	
	Valve spring					C				C	
	Distribution chain									S	
	Distribution chain slider									S	
	Clutch disc wear			C		S		C		S	
	Clutch cup springs			C		C		C		S	
	Clutch hub - basket wear			C		C		C		C	
	Gearbox bearing (crankcase side)									S	
	Surface appearance of the gearbox									C	
	Water pump seals									S	
	Oil pump control gears									S	
	Noise-absorbing material of the silencer			S		S		S		S	

The required engine maintenance is strongly depending on the level of use and on the accordingly done periodic checks and service.

The mentioned maintenance intervals are for the normal use of the vehicle, subject to the condition that the engine was never running under extraordinary conditions and the periodic service was done accurately.

		Running-in	Coupon 1 - 10 hours	Coupon 2 - 20 hours	Coupon 3 - 30 hours	Coupon 4 - 40 hours	Coupon 5 - 50 hours	Coupon 6 - 60 hours	Coupon 7 - 70 hours	Coupon 8 - 80 hours	After every ride
Assembling groups	Coolant system tightness and coolant level	C	C	C	C	C	C	C	C	C	C
	Exhaust manifold tightness	C	C	C	C	C	C	C	C	C	C
	Throttle control cables sliding and regulation	C	C	C	C	C	C	C	C	C	C
	Liquid level clutch pump	C		C		C		C		C	
	Airbox and air filter	P									P
	Chain, plate wheel and pinion	C	C	C	C	C	C	C	C	C	C
	Read the error memory with a BST diagnosis tester	C	C	C	C	C	C	C	C	C	
	Operation of the electric system by blowing and greasing the main connections	C	C	C	C	C	C	C	C	C	
	Check and recharge the 12V battery	C	C	C	C	C	C	C	C	C	C
Brake	Liquid level	C	C	C	C	C	C	C	C	C	C
	Pads thickness		C	C	C	C	C	C	C	C	
	Disc thickness	C		C		C		C		C	C
	Pipe tightness	C	C	C	C	C	C	C	C	C	C
	Idle travel levers and drives sliding	C	C	C	C	C	C	C	C	C	C
Cycling	Chassis	C		C		C		C		C	
	Swing arm	C		C		C		C		C	
	Mobile parts	C	C	C	C	C	C	C	C	C	C
	Shock absorber and telescopic fork tightness	C		C		C		C		C	
	Fork and rear shock absorber oil					S				S	
	Rear suspension linkage	C	C	C	C	C	C	C	C	C	
	Dust seal	C		C		C		C		C	
	Fuel lines	C		C		C		C		C	
	Bearings of steering	C		C		C		C		C	
	Bolts	T	T	T	T	T	T	T	T	T	C
Wheels	Wheel spokes and rim coaxiality	C	C	C	C	C	C	C	C	C	C
	Tyres (wear and pressure)	C	C	C	C	C	C	C	C	C	C
	Bearings clearance	C	C	C	C	C	C	C	C	C	

Key

C Check (Clean, adjust, lubricate, replace as necessary)**S Replace/renew****R Adjust****P Clean****T Tighten**

WARNING:

For any service requirements, please contact Betamotor's Authorized Service Network.

TIGHTENING TORQUE OVERVIEW

Here below is an overview of the tightening torque of all pieces subject to adjustment or maintenance:

Forecarriage		
	Tightening torque [Nm]	Threadlock
Wheel pin	50	
Fork foots - wheel pin	20*	
Brake caliper - Fork	35	M
U-bolt fork tube protection	1,5	
Steering head base - fork legs	12*	
Steering head - fork legs	17*	
Stem pin on steering head	20	
Lower handlebar u-bolt - steering head	40	M
Upper handlebar u-bolt - lower handlebar u-bolt	25	
Steering head clearance adjustment nut	30	

Rear axle		
	Tightening torque [Nm]	Threadlock
Wheel pin	130	
Rear shock absorber - frame	50	
Rear shock absorber - rocker arm	50	
Connecting rod - frame	90	
Connecting rod - rocker arm	90	
Rocker arm - swinging arm	90	

Engine		
	Tightening torque [Nm]	Threadlock
Engine oil drain plug	15	
Paper oil filter plug	10	
Gearbox oil drain plug	20	

M Medium strength threadlock

*



WARNING:

Tightening of the screws should be carried out by adjusting the torque wrench to the stability torque with repeated tightening until stability torque has been achieved.

Fairings		
	Tightening torque [Nm]	Notes
Fuel tank to the frame	10	Grease
Fuel tank fairings to the radiator	7	
Rear mudguard	5	M6
Small frame to frame	35	Medium strength threadlocker
Filter box arms to the frame	35	Medium strength threadlocker

CHAPTER 5 REMOVING AND INSTALLING SUPERSTRUCTURES

CONTENTS

Removing and installing of the saddle.....	68
Removing and installing air filter cover panel.....	69
Removing and installing side panels and rear mudguard	70
Removing and installing of the tank	72
Removing and installing the headlamp mask	75

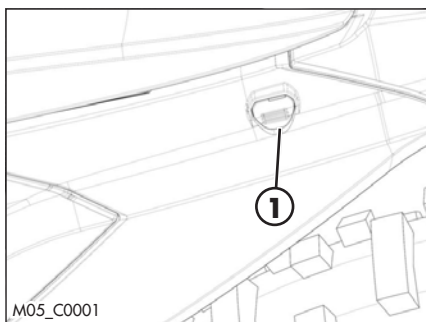

REMOVING AND INSTALLING OF THE SADDLE

Press button **1**.

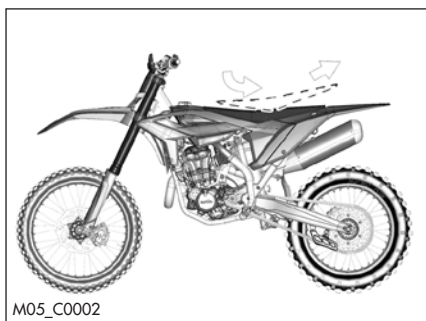

Remove the saddle towards the rear of the motorcycle.

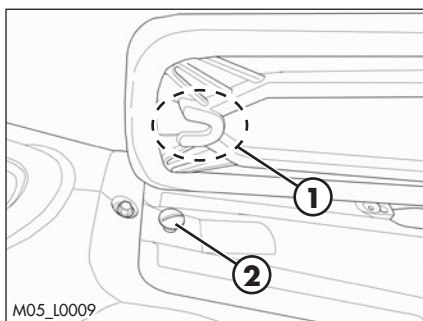

To re-assemble:
Insert the cavity **1** of the saddle in slot **2**.

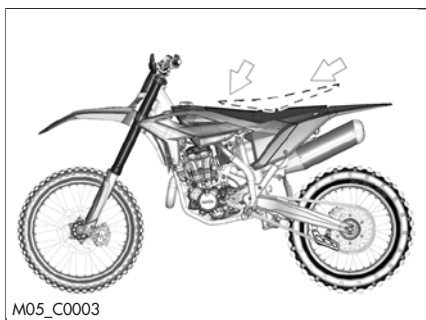

Press the saddle down in the middle and at the same time, push it forwards until the bayonet joint engages in its seat.

**WARNING**

Make sure the bayonet joint **3** is firmly inserted into the button lock.

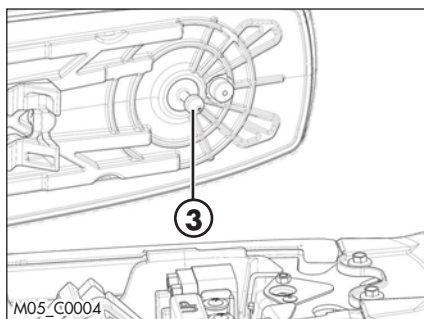

REMOVING AND INSTALLING AIR FILTER COVER PANEL

Grab the side panel at the point indicated by **1** and pull out.

To refit insert the tabs **2** into their slots.

Slide the side panel toward the vehicle.

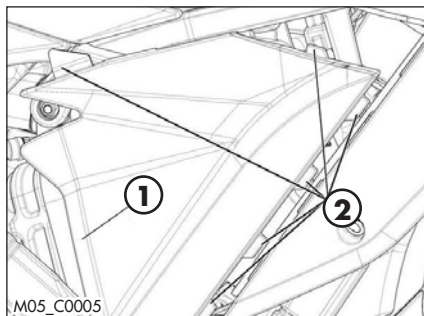

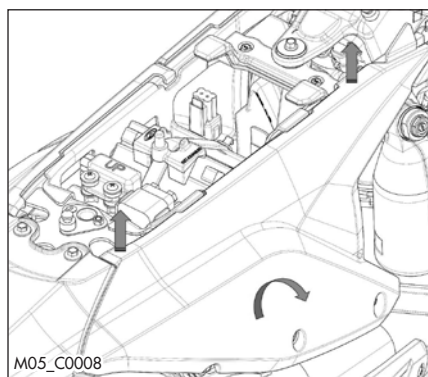
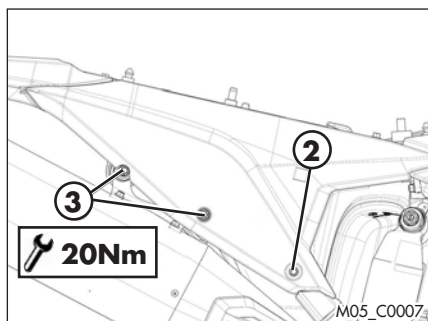
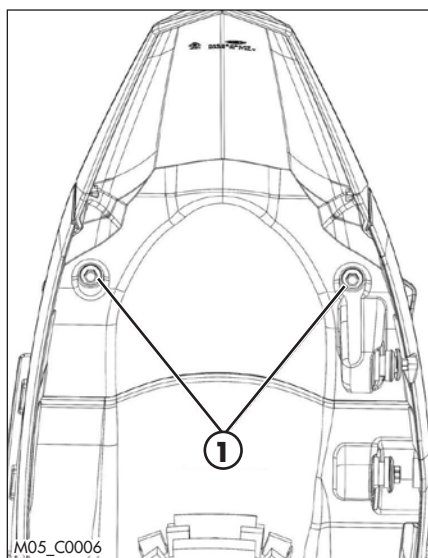

REMOVING AND INSTALLING SIDE PANELS AND REAR MUDGUARD

To remove the rear side panels it is necessary to:

- remove the seat (page 68);
- remove screws **1** that secure the rear mudguard to the side panels.

- Remove screw **2** of the right side panel.
- Remove the right front side panel to release the tab on the right rear side panel, located in the top right corner.

- Grasp the right side panel at the top and pull out the tabs that embrace the frame in the direction indicated by the arrows, turn the side panel clockwise as indicated and release the lower tabs and the tab at the top left.

- Remove screw **4** from the left side panel and follow the same procedure as for the right side panel by turning it anti-clockwise. Removal of the front side panel, which in this case does not secure the side panel, should be excluded.

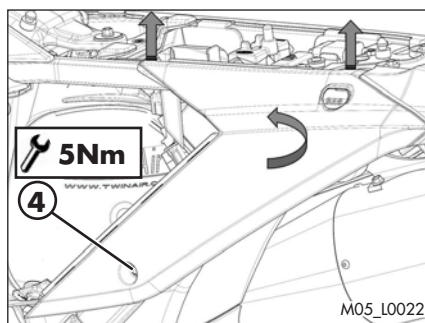

In order to remove the rear mudguard, it is necessary to:

- Remove the silencer by unscrewing screws **3**, taking care not to damage the vehicle.
- Remove screws **5** and slide the mudguard towards the rear.

For reassembly, proceed inversely compared to the previously-described disassembly procedures. Refer to the tightening torques, where indicated.

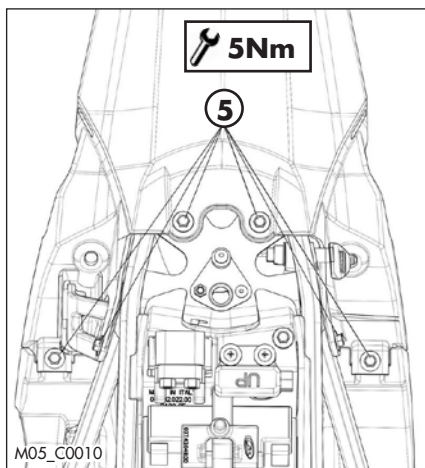

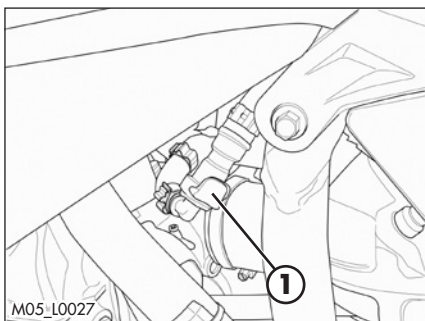

REMOVING AND INSTALLING OF THE TANK

Disconnect the fuel tank vent pipe.

Disconnect the fuel hose **1** by pressing the appropriate button of the quick coupling.



WARNING:

Follow action on a cold engine and in a well ventilated area.



WARNING:

Fire hazard. Fuel is highly flammable.



Always stop the engine when refuelling and keep open flames and lighted cigarettes away.



Immediately clean up any spilled fuel.

Remove the saddle (page 68).

Remove the screw **2** fastening the tank to the frame and the screws **3** (one per side) securing the fairing to the radiator.

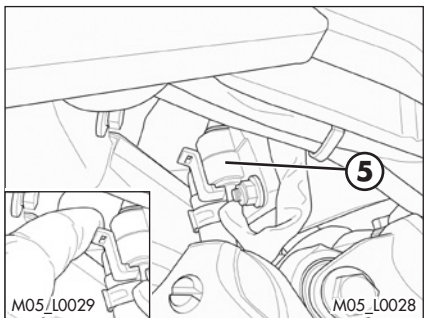
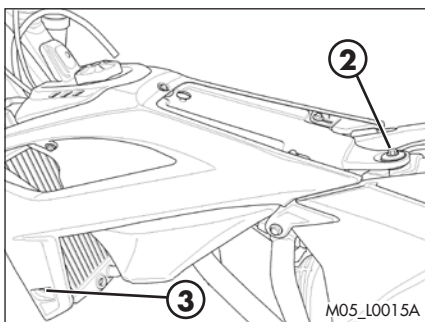

Disconnect the electrical connector **5**.

Lift the tank backwards and remove the tank towards the rear.

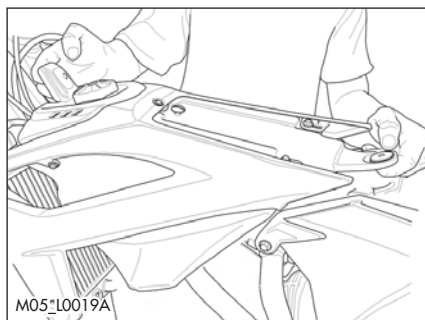

To refit the tank proceed as follows:
Push the tank towards the front of the vehicle and down.

Tighten the tank screws to the torques given.

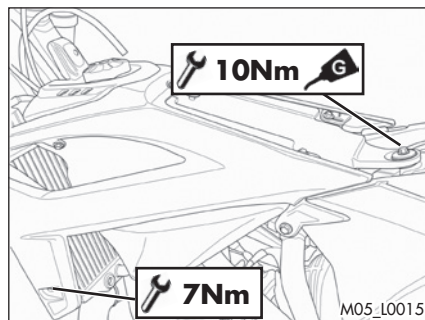

Connect the fuel connections by coupling them completely.

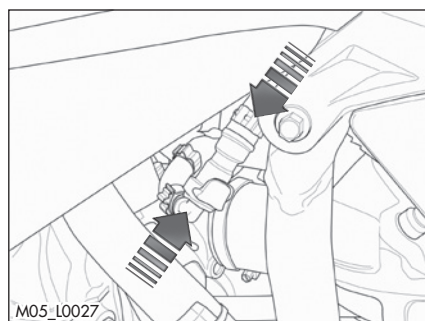

WARNING

For safety reason, the fuel flow is stopped when the connector is even partially engaged.
Make sure that the fuel quick release fittings are well inserted.

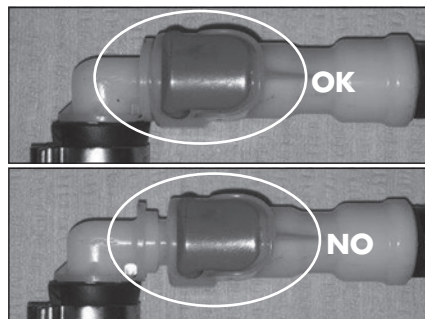

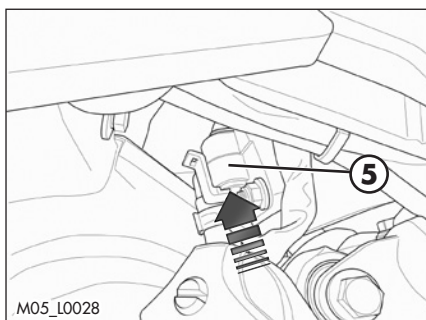

Reconnect the connector **5**.

Refit the saddle (page 68) and the vent pipe.

REMOVING AND INSTALLING THE FRONT MASK

Remove the screw **1**.

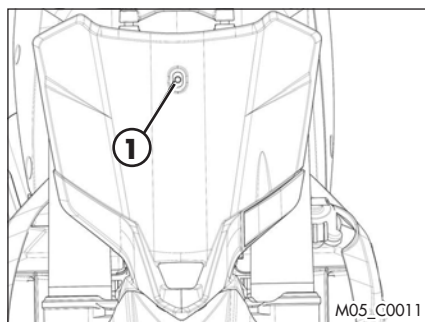

Remove the front mask in the direction indicated by the arrow.

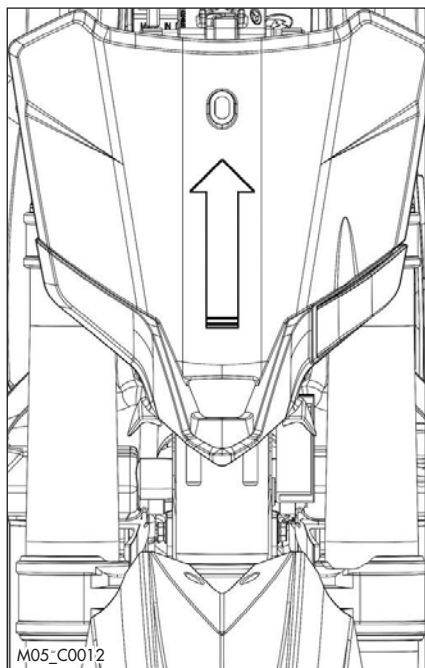

Rotate the front mask to allow easy access to screw **2** to unscrew, located behind. Then remove the cable gland.

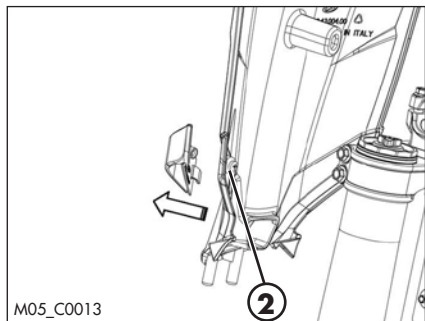

CHAPTER 6 TROUBLESHOOTING

CONTENTS

Troubleshooting	78
Alphabetical index	79

6 TROUBLESHOOTING

TRUBLESHOOTING

PROBLEM	CAUSE	REMEDY
The electric starter does not turn	Decompressor failure	Contact authorised BETAMOTOR customer service
	Flat battery	Check the battery
	Blown fuse	Replace
	Defective relay	Contact authorised BETAMOTOR customer service
	Defective starter motor	Contact authorised BETAMOTOR customer service
The engine rotates, but does not start	Fuel quick release fittings incorrectly inserted	Check that the fuel quick release fittings are properly inserted (page 72)
	Spark plug dirty	Clean or replace the spark plug
	Spark gap wrongly adjusted	Restore the spark gap
	Faulty ignition/injection system	Contact authorised BETAMOTOR customer service
MIL warning light	Several reasons	Contact authorised BETAMOTOR customer service
The motor stops or splutters	Lack of fuel	Refuel
Engine overheats	Radiator grill blocked	Remove and clean the grill
	Radiator (air side) blocked	Clean the radiator
	Insufficient air flow	Check that the cooling fan is working correctly
	Silencer partly clogged	Contact authorised BETAMOTOR customer service
Front braking poor	Brake pads worn	Contact authorised BETAMOTOR customer service
	Air or humidity in the hydraulic circuit	Contact authorised BETAMOTOR customer service
Rear braking poor	Brake pads worn	Contact authorised BETAMOTOR customer service
	Air or humidity in the hydraulic circuit	Contact authorised BETAMOTOR customer service

ALPHABETICAL INDEX

Adjusting fork	27
Adjustment of gas clearance	25
Air filter	38
Battery	55
Brakes	24
Chain	53
Check and adjusting of steering play	50
Checks before and after use	18
Cleaning the vehicle	58
Clutch	25
Clutch control	48
Electrical connector maintenance	59
Electrical system	14
Engine mapping adjustment and traction control activation	30
Engine oil	32
Engine shut-down	20
Familiarizing with the vehicle	9
Fork	51
Front brake	42
Front wheel	51
Fuelling	19
Fuses	13
Fuses	57
Gearbox oil	34
Handlebar adjustment	26
Idle adjustment	25
Key to symbols	24
Liquid coolant	35

Main parts	16
Operating instructions.....	5
Prolonged inactivity	61
Rear brake	45
Rear suspension leverage.....	52
Recommended lubricants and liquid	13
Removing and installing air filter cover panel.....	69
Removing and installing of the saddle.....	68
Removing and installing of the tank	72
Removing and installing side panels and rear mudguard	70
Removing and installing the front mask	75
Riding safety	6
Running in.....	18
Scheduled maintenance vehicle	62
Shock absorber.....	28
Spark plug	41
Specifications	10
Starting the engine	20
Symbols.....	5
Tightening torque overview	64
Tools kit	8
Troubleshooting	78
Tyres.....	52
Vehicle identification data	8
Vehicle preparation for use in heavy-duty conditions.....	21